

INDEX

STANDARD SECTIONS	PAGE
1. Bars	
1.1 Round	01
1.2 Square	03
1.3 Hexagonal	04
1.4 Flat	05
2. Tubes	
2.1 Round	14
2.2 Square	25
2.3 Rectangular	27
3. Angles	
3.1 Equal	30
3.2 Unequal	32
4. Channels	
4.1 Equal	34
4.2 Unequal	35
5. Tees	
5.1 Regular	37
5.2 Bulb	38
6. Modular	39

BARS : ROUND

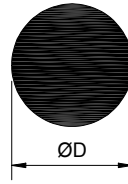

Section No	D	Kg/m	Section No	D	Kg/m	Section No	D	Kg/m
RBR 1001101	5.00	0.060	RBR 2015002	18.20	0.702	RBR 3006266	31.00	2.037
RBR 1006284	5.00	0.053	RBR 3006290	18.30	0.710	RBR 2015013	31.00	2.037
RBR 1001102	6.00	0.076	RBR 2006219	18.70	0.741	RBR 2001115	31.75	2.130
RBR 1006285	6.00	0.076	RBR 2015030	18.70	0.741	RBR 2001125	32.00	2.170
RBR 1001137	6.35	0.088	RBR 2015003	19.00	0.765	RBR 2006228	32.00	2.171
RBR 2001124	7.00	0.103	RBR 2001111	19.05	0.773	RBR 2015033	32.00	2.171
RBR 2001103	7.90	0.130	RBR 2006292	19.30	0.789	RBR 2015027	33.00	2.309
RBR 2006221	8.00	0.135	RBR 2015054	19.70	0.822	RBR 2006203	33.30	2.351
RBR 1001108	8.20	0.145	RBR 2006201	20.00	0.847	RBR 2015049	33.50	2.379
RBR 1015043	9.00	0.171	RBR 2006211	20.00	0.848	RBR 2006251	34.00	2.451
RBR 2001104	9.50	0.191	RBR 3006278	20.00	0.848	RBR 2015028	34.00	2.451
RBR 1001105	10.00	0.210	RBR 2015004	20.20	0.865	RBR 2006213	35.00	2.597
RBR 2006209	10.00	0.212	RBR 3006287	20.50	0.891	RBR 2015034	35.50	2.672
RBR 2001106	11.00	0.257	RBR 2001110	21.00	0.934	RBR 2001123	36.00	2.740
RBR 2015029	11.15	0.263	RBR 3006283	21.30	0.962	RBR 2006294	36.50	2.825
RBR 2015039	11.50	0.280	RBR 2006299	21.50	0.980	RBR 3015023	37.00	2.903
RBR 2001119	12.00	0.305	RBR 2006235	22.00	1.026	RBR 2006252	38.00	3.062
RBR 2006218	12.00	0.305	RBR 2001113	22.20	1.045	RBR 2001121	38.10	3.080
RBR 2001107	12.70	0.341	RBR 2001138	22.50	1.072	RBR 3015017	38.50	3.143
RBR 2015005	13.20	0.369	RBR 3006274	23.00	1.121	RBR 2006202	40.00	3.392
RBR 2015044	13.60	0.392	RBR 2015040	23.00	1.121	RBR 2006208	40.00	3.392
RBR 2015007	14.60	0.452	RBR 2006260	24.00	1.221	RBR 3006277	40.00	3.392
RBR 2001120	15.00	0.477	RBR 2001129	24.50	1.272	RBR 3015011	40.00	3.392
RBR 2006210	15.00	0.477	RBR 2006212	25.00	1.325	RBR 2006295	40.50	3.478
RBR 2015010	15.00	0.477	RBR 2001114	25.40	1.368	RBR 3006267	40.20	3.426
RBR 2006279	15.10	0.483	RBR 2001135	26.00	1.432	RBR 2006241	41.27	3.611
RBR 2006205	16.00	0.542	RBR 2006256	26.00	1.433	RBR 2006253	42.00	3.740
RBR 2015000	16.00	0.542	RBR 2015016	26.00	1.433	RBR 3015012	42.00	3.740
RBR 2001109	16.10	0.550	RBR 2015031	26.00	1.433	RBR 3015036	42.00	3.740
RBR 2015006	16.20	0.556	RBR 3006265	26.50	1.489	RBR 3006276	43.00	3.920
RBR 2015042	16.70	0.591	RBR 2006222	27.00	1.545	RBR 2015014	44.00	4.105
RBR2015022	16.80	0.598	RBR 3006275	27.00	1.545	RBR 3006240	44.45	4.189
RBR 2001112	17.00	0.616	RBR 2015020	27.20	1.568	RBR 3015063	44.80	4.256
RBR 3006286	17.20	0.627	RBR 2006220	28.00	1.662	RBR 2006214	45.00	4.294
RBR 2015001	17.20	0.627	RBR 2006293	28.20	1.686	RBR 2001118	45.00	4.500
RBR 3006238	18.00	0.687	RBR 2001122	28.58	1.730	RBR 3006268	45.20	4.332
RBR 3006264	18.00	0.687	RBR 2015032	28.70	1.746	RBR 3015018	46.00	4.487
RBR 2006280	18.10	0.694	RBR 2006206	30.00	1.909	RBR 2015015	47.00	4.684

BARS : ROUND

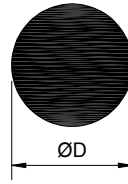

Section No	D	Kg/m	Section No	D	Kg/m	Section No	D	Kg/m
RBR 2001126	47.50	4.784	RBR 3006255	80.00	13.571			
RBR 3015037	48.50	4.988	RBR 3006282	80.30	13.673			
RBR 2006215	50.00	5.301	RBR 3015062	81.00	13.913			
RBR 2006254	50.00	5.301	RBR 3006249	82.00	14.258			
RBR 3006269	50.20	5.343	RBR 3015057	82.55	14.450			
RBR 2001116	50.80	5.470	RBR 3015008	83.00	14.608			
RBR 3015066	50.80	5.470	RBR 3006227	85.00	15.321			
RBR 3006239	51.00	5.515	RBR 3006298	86.10	15.720			
RBR 3006257	52.00	5.734	RBR 2001131	90.00	17.176			
RBR 3006297	52.40	5.822	RBR 3015046	90.00	17.176			
RBR 3015038	52.50	5.844	RBR 3015050	91.00	17.560			
RBR 2006216	55.00	6.414	RBR 3006291	92.00	17.948			
RBR 3015047	55.00	6.414	RBR 2001133	95.00	19.128			
RBR 3006259	56.00	6.650	RBR 3006281	97.00	19.952			
RBR 2001136	57.00	6.886	RBR 3006261	101.60	21.889			
RBR 3006296	57.15	6.926	RBR 3006273	106.00	23.826			
RBR 3006270	57.40	6.986	RBR 3006272	108.00	24.730			
RBR 3015019	58.00	7.133	RBR 3015009	100.00	21.205			
RBR 2006217	60.00	7.634	RBR 3015026	105.00	23.379			
RBR 3015055	60.32	7.715	RBR 3015065	107.95	24.711			
RBR 3006288	61.00	7.890	RBR 3015045	110.00	25.658			
RBR 2006225	61.50	8.020	RBR 3006263	111.00	26.127			
RBR 3006250	62.00	8.151	RBR 3015064	114.30	27.704			
RBR 3006258	63.00	8.416	RBR 4015058	115.00	28.044			
RBR 2001117	63.50	8.546	RBR 4015059	120.00	30.536			
RBR 3006271	63.70	8.604	RBR 4015061	120.65	30.867			
RBR 2001132	65.00	8.954	RBR 4015060	130.00	35.837			
RBR 3015051	65.00	8.959						
RBR 3015056	66.67	9.425						
RBR 3015024	68.00	9.805						
RBR 3015025	68.20	9.863						
RBR 2006223	70.00	10.390						
RBR 3006289	71.00	10.689						
RBR 2001134	72.00	10.980						
RBR 2001130	75.00	11.930						
RBR 3015052	75.00	11.928						
RBR 2006224	76.20	12.312						
RBR 3006242	80.00	13.571						

BARS : FLAT

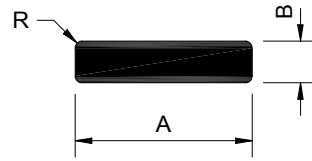

Section No	A	B	R	Kg/m	Section No	A	B	R	Kg/m
FBR 1010222	8.00	5.00		0.107	FBR 2001005	15.87	6.35		0.270
FBR 2000171	8.70	7.70		0.185	FBR 2001006	15.87	9.52		0.408
FBR 2010238	9.00	7.00		0.169	FBR 2010352	15.90	9.57		0.410
FBR 1010177	10.00	3.00		0.080	FBR 2001007	16.00	9.00		0.389
FBR 1010124	10.00	4.00		0.107	FBR 2010347	16.00	12.80	1.00	0.550
FBR 2010140	10.00	5.00		0.134	FBR 2010133	16.75	3.70		0.166
FBR 2000166	10.00	6.00		0.162	FBR 1010106	17.00	3.00		0.137
FBR 2010139	10.00	6.00		0.161	FBR 2001095	17.00	4.25		0.195
FBR 2006153	10.00	8.00		0.216	FBR 1010333	17.30	2.00		0.092
FBR 2010152	11.00	8.20		0.243	FBR 2010305	17.47	8.25	1.60	0.383
FBR 2010329	11.11	7.95		0.237	FBR 2000135	17.50	2.40		0.113
FBR 2010308	11.20	8.40		0.253	FBR 2000184	17.50	3.10		0.150
FBR 2010400	11.55	7.92		0.246	FBR 1010288	18.00	2.50		0.120
FBR 1010339	12.00	2.00		0.064	FBR 2010316	18.54	14.22		0.711
FBR 1010289	12.00	2.50		0.080	FBR 2001080	19.00	4.00		0.205
FBR 2001002	12.00	3.00		0.097	FBR 2006011	19.00	16.00		0.820
FBR 2006198	12.00	5.00		0.161	FBR 1002151	19.05	2.00		0.112
FBR 2001003	12.70	6.35		0.218	FBR 1001014	19.05	2.80		0.144
FBR 2010259	12.70	8.13		0.278	FBR 2001009	19.05	6.40		0.330
FBR 1000104	14.00	3.10		0.113	FBR 1006079	20.00	2.00		0.107
FBR 2010290	14.30	12.70	2.00	0.481	FBR 1006104	20.00	3.00		0.161
FBR 1006049	14.80	8.80		0.351	FBR 2010083	20.00	4.00		0.215
FBR 1006050	14.80	10.33		0.412	FBR 2006055	20.00	5.00		0.269
FBR 1006051	14.80	10.80		0.432	FBR 2000181	20.00	6.00	3.00	0.325
FBR 1006052	14.80	12.60		0.503	FBR 2010103	20.00	6.00		0.323
FBR 1001027	15.00	2.20		0.090	FBR 2010223	20.00	7.00		0.377
FBR 1010332	15.00	3.00	1.00	0.119	FBR 3006111	20.00	8.00		0.431
FBR 1010121	15.00	3.00		0.120	FBR 2006099	20.00	10.00		0.539
FBR 2010138	15.00	4.00		0.161	FBR 2010091	20.00	12.00		0.647
FBR 2010137	15.00	5.00		0.201	FBR 3006112	20.00	15.00		0.809
FBR 2010134	15.00	4.50		0.181	FBR 2010307	22.00	20.00	1.00	1.185
FBR 2000176	15.00	6.00	3.00	0.245	FBR 2006139	22.25	16.00		0.960
FBR 2010147	15.00	6.00		0.242	FBR 2010294	22.40	15.10		0.912
FBR 2010197	15.00	8.00		0.323	FBR 2001096	22.50	2.90		0.175
FBR 2000182	15.00	8.10		0.325	FBR 2010296	22.50	4.00		0.242
FBR 2010075	15.00	10.00		0.405	FBR 2006140	23.80	17.50		1.123
FBR 3010208	15.00	12.00		0.485	FBR 2010310	24.00	14.00		0.906
FBR 2010260	15.75	9.53		0.404	FBR 1000152	25.00	1.20		0.081

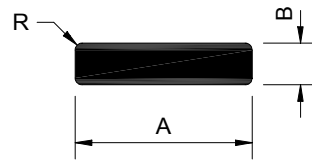
BARS : FLAT

Section No	A	B	R	Kg/m	Section No	A	B	R	Kg/m
FBR 1002161	25.00	1.50		0.108	FBR 2006013	30.00	5.00		0.405
FBR 1010287	25.00	2.00		0.134	FBR 2006014	30.00	6.00		0.486
FBR 2001010	25.00	2.50		0.169	FBR 2000178	30.00	6.00	3.00	0.490
FBR 1001011	25.00	3.00		0.216	FBR 2006056	30.00	8.00		0.647
FBR 2006092	25.00	4.00		0.269	FBR 2006095	30.00	10.00		0.809
FBR 2006010	25.00	5.00		0.338	FBR 2006172	30.00	10.00	5.00	0.752
FBR 2000177	25.00	6.00	3.00	0.405	FBR 2006101	30.00	12.00		0.971
FBR 2010146	25.00	6.00		0.404	FBR 2006178	30.00	15.00		1.214
FBR 2006002	25.00	8.00		0.539	FBR 3006109	30.00	20.00		1.619
FBR 2006036	25.00	8.00		0.539	FBR 2010096	30.00	25.00		2.024
FBR 2010021	25.00	10.00		0.674	FBR 3010241	30.00	25.00	5.00	1.967
FBR 2006100	25.00	12.00		0.809	FBR 2000222	30.20	17.70	3.30	1.418
FBR 2010001	25.00	15.00		1.011	FBR 3010291	30.20	28.60	2.50	2.317
FBR 2006177	25.00	20.00		1.349	FBR 2000116	31.00	9.50		0.795
FBR 2001012	25.20	4.00		0.272	FBR 2001019	31.75	2.60		0.290
FBR 1002152	25.40	2.00		0.137	FBR 1001020	31.75	3.17		0.270
FBR 2001015	25.40	3.20		0.220	FBR 1001037	31.75	3.50		0.300
FBR 2001016	25.40	4.76		0.326	FBR 2001021	31.75	4.76		0.404
FBR 2001017	25.40	6.40		0.440	FBR 2000140	31.75	4.76		0.424
FBR 2010306	25.40	8.25	1.60	0.559	FBR 2001022	31.75	6.35		0.544
FBR 2001018	25.40	9.50		0.650	FBR 3006116	31.75	7.93		0.679
FBR 2001086	25.40	12.70		0.870	FBR 2001023	31.75	9.52		0.810
FBR 3006115	25.40	15.87		1.087	FBR 3006117	31.75	25.40		2.176
FBR 2006141	25.40	19.05		1.305	FBR 2010336	31.80	4.00	1.00	0.341
FBR 3010325	25.40	21.40	2.00	1.458	FBR 3010346	31.85	22.25	2.40	1.900
FBR 1010334	26.00	1.50		0.104	FBR 2010240	32.00	4.00		0.345
FBR 2000115	26.00	2.80		0.196	FBR 3010190	32.00	10.00		0.863
FBR 2000161	28.00	10.00		0.755	FBR 3010380	32.00	16.00		1.381
FBR 3010311	28.58	23.01		1.775	FBR 3010341	32.00	25.00		2.159
FBR 2006137	28.65	22.50		1.740	FBR 3010322	32.00	27.00	1.00	2.330
FBR 3010304	28.70	25.40	2.50	1.953	FBR 3010132	33.50	23.00	1.00	2.079
FBR 3010303	27.00	25.00		1.821	FBR 1010286	35.00	1.75		0.164
FBR 2010340	29.00	15.00		1.173	FBR 2006147	35.00	4.00		0.377
FBR 2006094	30.00	2.00		0.161	FBR 3010141	35.00	5.00		0.471
FBR 1010270	30.00	2.50		0.201	FBR 2006084	35.00	6.00	6.00	0.525
FBR 1010335	30.00	3.00	1.00	0.240	FBR 2010295	35.00	6.00		0.566
FBR 2006093	30.00	3.00		0.242	FBR 2006037	35.00	8.00		0.755
FBR 2006082	30.00	4.00		0.323	FBR 3010122	35.00	10.00		0.944

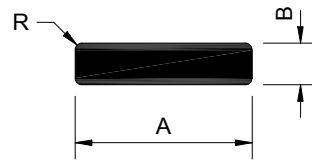
BARS : FLAT

Section No	A	B	R	Kg/m	Section No	A	B	R	Kg/m
FBR 3010204	35.00	12.00		1.133	FBR 3010183	40.00	12.00		1.295
FBR 2006135	35.00	15.00		1.416	FBR 3010189	40.00	12.50		1.349
FBR 2010070	35.00	20.00		1.889	FBR 2001030	40.00	15.00		1.620
FBR 2010071	35.00	25.00		2.361	FBR 2010062	40.00	15.00		1.620
FBR 3010203	35.00	30.00		2.834	FBR 2006152	40.00	15.00	7.50	1.489
FBR 2000185	36.00	1.60		0.155	FBR 2010406	40.00	16.00	1.50	1.722
FBR 2001025	37.00	3.80		0.380	FBR 2001093	40.00	19.05	1.00	2.050
FBR 2000146	37.00	4.40		0.440	FBR 2006019	40.00	20.00		2.160
FBR 1010337	38.00	1.50		0.153	FBR 2006148	40.00	20.00	2.00	2.150
FBR 2002156	38.00	3.17		0.332	FBR 2006179	40.00	25.00		2.699
FBR 3010281	38.00	10.00		1.025	FBR 2006054	40.00	25.00	2.00	2.690
FBR 2001087	38.00	12.70		1.300	FBR 2006180	40.00	30.00		3.239
FBR 3010232	38.00	23.00	1.80	2.352	FBR 3010236	40.00	35.00	1.80	3.772
FBR 1002158	38.10	2.00		0.205	FBR 2010252	41.00	4.00	1.00	0.440
FBR 2001026	38.10	3.17		0.326	FBR 2010253	41.00	5.00	1.00	0.551
FBR 2002155	38.10	4.00		0.411	FBR 2006138	41.50	28.50		3.192
FBR 2001028	38.10	6.35		0.653	FBR 3010226	41.50	32.00	2.00	3.576
FBR 3010225	38.10	8.00	1.00	0.820	FBR 2000145	42.00	5.40		0.612
FBR 2001029	38.10	9.52		0.979	FBR 2001031	44.00	6.40		0.750
FBR 3010360	38.10	19.05	1.00	1.957	FBR 3006133	45.00	5.00		0.606
FBR 3006118	38.10	25.40		2.612	FBR 3010144	45.00	10.00		1.214
FBR 3006119	38.10	31.75		3.265	FBR 3010209	45.00	15.00		1.821
FBR 3010300	39.00	26.00	1.00	2.735	FBR 3010274	45.00	16.00	1.00	1.941
FBR 2010145	40.00	2.00		0.215	FBR 2010107	45.00	20.00		2.429
FBR 2006057	40.00	3.00		0.323	FBR 2010037	45.00	25.00		3.036
FBR 2006080	40.00	4.00		0.431	FBR 3010395	45.00	30.00	1.00	3.642
FBR 2001076	40.00	5.00	1.00	0.536	FBR 2000194	45.00	32.00		3.887
FBR 2006015	40.00	5.00		0.540	FBR 2010038	45.00	35.00		4.251
FBR 2000179	40.00	6.00		0.650	FBR 1010338	46.00	2.00		0.247
FBR 2006016	40.00	6.00		0.648	FBR 2010368	49.53	7.14	1.52	0.949
FBR 2006017	40.00	8.00		0.864	FBR 2006081	50.00	2.00		0.269
FBR 2000189	40.00	10.00		1.080	FBR 2002159	50.00	3.00		0.425
FBR 2006018	40.00	10.00		1.080	FBR 3010123	50.00	3.00		0.404
FBR 2010061	40.00	10.00		1.080	FBR 3010173	50.00	4.00		0.539
FBR 3010174	40.00	10.00	2.00	1.070	FBR 2002157	50.00	4.65		0.627
FBR 2006171	40.00	10.00	5.00	1.022	FBR 2001035	50.00	4.65		0.628
FBR 2006160	40.00	12.00	3.00	1.275	FBR 2006020	50.00	5.00		0.675
FBR 2010002	40.00	12.00		1.295	FBR 2010046	50.00	5.00		0.675

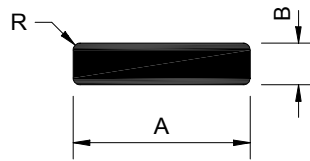
BARS : FLAT

Section No	A	B	R	Kg/m	Section No	A	B	R	Kg/m
FBR 2010213	50.00	5.00	2.50	0.660	FBR 3006121	50.80	31.75		4.354
FBR 2006021	50.00	6.00		0.810	FBR 3006122	50.80	38.10		5.225
FBR 3010185	50.00	6.00		0.809	FBR 2000170	51.00	22.00		3.029
FBR 2000180	50.00	6.00	3.00	0.810	FBR 3010254	51.00	36.50	1.50	5.020
FBR 2010206	50.00	6.00	3.00	0.789	FBR 2000169	51.50	41.50	1.00	5.770
FBR 2006022	50.00	8.00		1.080	FBR 2000159	52.00	3.20		0.449
FBR 3010269	50.00	8.00	4.00	1.042	FBR 2001085	52.00	4.50		0.630
FBR 2000121	50.00	10.00	1.50	1.344	FBR 2001036	52.00	5.00		0.700
FBR 3010280	50.00	10.00	3.00	1.329	FBR 2006047	53.00	32.00		4.579
FBR 2001088	50.00	10.00		1.350	FBR 3010257	54.00	42.00		6.123
FBR 2006023	50.00	10.00		1.350	FBR 2000119	55.00	3.20		0.457
FBR 2006170	50.00	10.00	5.00	1.292	FBR 3010273	55.00	16.00	1.00	2.373
FBR 2006103	50.00	12.00		1.619	FBR 2006053	55.00	34.00	2.00	5.039
FBR 3006134	50.00	12.00	2.00	1.610	FBR 2001083	57.00	5.00		0.768
FBR 3010279	50.00	12.00	6.00	1.536	FBR 2001042	57.15	44.45		6.859
FBR 2006106	50.00	15.00		2.024	FBR 2000175	58.00	3.20		0.501
FBR 2010063	50.00	15.00		2.024	FBR 2000224	59.54	6.35		1.020
FBR 2006091	50.00	16.00		2.159	FBR 1010198	60.00	2.00		0.323
FBR 2006073	50.00	17.50	3.00	2.348	FBR 1010199	60.00	3.00		0.485
FBR 2006024	50.00	20.00		2.700	FBR 2010025	60.00	4.00		0.647
FBR 2010064	50.00	20.00		2.700	FBR 2006096	60.00	5.00		0.809
FBR 2006088	50.00	25.00		3.374	FBR 2010202	60.00	5.00	2.50	0.795
FBR 2010051	50.00	25.00		3.374	FBR 2006025	60.00	6.00		0.972
FBR 2006074	50.00	30.00		4.043	FBR 3010233	60.00	6.00	1.00	0.969
FBR 2010065	50.00	30.00		4.043	FBR 2000191	60.00	6.00	3.00	0.951
FBR 2010039	50.00	35.00		4.724	FBR 2010214	60.00	6.00	3.00	0.951
FBR 3010053	50.00	40.00		5.399	FBR 2001043	60.00	8.00	2.00	1.290
FBR 3010056	50.00	40.00	2.00	5.390	FBR 2006154	60.00	8.00		1.295
FBR 3010247	50.50	40.50		5.520	FBR 2006069	60.00	8.00		1.295
FBR 1010396	50.80	3.17		0.434	FBR 2010060	60.00	8.00	4.00	1.258
FBR 2001038	50.80	6.40		0.880	FBR 2010215	60.00	8.00	4.00	1.258
FBR 2006176	50.80	6.80	1.00	0.930	FBR 2000103	60.00	10.00	1.50	1.615
FBR 3010277	50.80	6.80	3.40	0.905	FBR 1010353	60.00	10.00	1.50	1.615
FBR 2001039	50.80	12.70		1.742	FBR 2001041	60.00	10.00		1.620
FBR 3006120	50.80	15.87		2.176	FBR 2006026	60.00	10.00		1.620
FBR 2001040	50.80	19.05		2.612	FBR 2006169	60.00	10.00	5.00	1.562
FBR 2006142	50.80	25.40		3.483	FBR 2006107	60.00	12.00		1.943
FBR 3010156	50.80	27.00		3.702	FBR 2010059	60.00	12.00	6.00	1.860

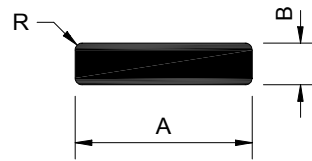
BARS : FLAT

Section No	A	B	R	Kg/m	Section No	A	B	R	Kg/m
FBR 2006075	60.00	15.00		2.429	FBR 3010143	70.00	6.00		1.133
FBR 2006150	60.00	16.00	8.00	2.443	FBR 2010027	70.00	8.00		1.511
FBR 2006027	60.00	20.00		3.240	FBR 2010055	70.00	10.00		1.889
FBR 2006039	60.00	25.00		4.049	FBR 2006062	70.00	12.00		2.267
FBR 3006113	60.00	30.00		4.859	FBR 2006059	70.00	15.00		2.834
FBR 2006007	60.00	40.00		6.480	FBR 2006076	70.00	20.00		3.779
FBR 2006114	60.00	40.00		6.480	FBR 2010097	70.00	25.00		4.724
FBR 3010099	60.00	35.00		5.669	FBR 2010010	70.00	30.00		5.669
FBR 3010036	60.00	46.00		7.451	FBR 3006182	70.00	35.00		6.614
FBR 3006181	60.00	50.00		8.099	FBR 3010012	70.00	40.00		7.559
FBR 2010370	60.25	7.50	0.80	1.218	FBR 3010105	70.00	43.00		8.126
FBR 3010078	62.00	42.00		7.030	FBR 3006183	70.00	50.00		9.449
FBR 2000147	63.00	3.50		0.595	FBR 3010267	72.00	40.00	20.00	6.848
FBR 2000148	63.00	4.20		0.680	FBR 3010079	72.00	52.00		10.108
FBR 2000126	63.00	12.00	1.50	2.035	FBR 2000199	74.00	3.20		0.639
FBR 2000118	63.00	26.00	1.00	4.420	FBR 3010301	74.50	35.50	1.00	7.138
FBR 2006159	63.50	9.50	3.00	1.607	FBR 1010135	75.00	2.00		0.404
FBR 2001044	63.50	12.70		2.170	FBR 2001045	75.00	5.00		1.000
FBR 3006123	63.50	15.87		2.720	FBR 3010116	75.00	6.00	3.00	1.194
FBR 3006124	63.50	19.05		3.265	FBR 2010195	75.00	6.00	3.00	1.194
FBR 3006125	63.50	25.40		4.354	FBR 3010172	75.00	8.00		1.619
FBR 3010169	63.50	32.00	1.00	5.484	FBR 2000111	75.00	10.00	2.00	2.025
FBR 3010397	63.50	38.10	1.00	6.529	FBR 2006164	75.00	10.00	5.00	1.967
FBR 3006126	63.50	44.45		7.620	FBR 2000127	75.00	12.00	1.50	2.424
FBR 3006127	63.50	50.80		8.709	FBR 2010182	75.00	12.00		2.429
FBR 2001073	64.00	5.00		0.860	FBR 3010205	75.00	12.00	6.00	2.346
FBR 2000163	64.00	10.00		1.727	FBR 3010243	75.00	14.00	7.00	2.721
FBR 2006158	65.00	12.00	3.00	2.105	FBR 2006008	75.00	16.00		3.240
FBR 2010076	65.00	20.00		3.510	FBR 3010131	75.00	16.00	2.00	3.230
FBR 2000186	65.00	25.00	1.00	4.387	FBR 3010373	75.00	16.00	8.00	3.091
FBR 3010357	65.00	50.00	2.00	8.765	FBR 2001082	75.00	20.00		4.050
FBR 3010355	66.00	20.00		3.563	FBR 2006089	75.00	25.00		5.061
FBR 3010120	67.00	51.00		9.225	FBR 3010239	75.00	26.00	1.00	5.262
FBR 2006046	67.50	21.00		3.826	FBR 2000218	75.70	3.00	1.00	0.620
FBR 3010302	67.50	35.50	1.00	6.467	FBR 2001048	76.20	6.40		1.310
FBR 2000174	68.00	10.00		1.835	FBR 2010369	76.20	7.92	1.52	1.624
FBR 2010090	70.00	4.00		0.755	FBR 3006128	76.20	7.93		1.630
FBR 2000192	70.00	6.00	3.00	1.113	FBR 3010278	76.20	8.40	4.20	1.687

BARS : FLAT

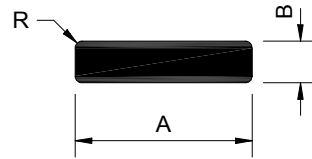

Section No	A	B	R	Kg/m	Section No	A	B	R	Kg/m
FBR 2010318	76.20	9.50	4.75	1.902	FBR 2006108	80.00	40.00	1.00	8.637
FBR 2010413	76.20	9.52	0.60	1.957	FBR 3010072	80.00	40.00		8.639
FBR 2001049	76.20	12.70		2.613	FBR 3010381	80.00	42.00	1.00	9.069
FBR 3010297	76.20	12.70	6.35	2.519	FBR 3010034	80.00	50.00		10.799
FBR 2006143	76.20	19.05		3.918	FBR 3010068	80.00	50.00		10.799
FBR 3006129	76.20	25.40		5.225	FBR 3010186	80.00	50.00	6.00	10.716
FBR 3010167	76.20	31.75	1.00	6.529	FBR 3010073	80.00	60.00		12.959
FBR 3006144	76.20	38.10		7.838	FBR 2006048	80.00	52.00		11.230
FBR 3010151	76.20	50.80		10.451	FBR 3010104	80.00	62.00		13.391
FBR 2000196	78.00	55.00		11.583	FBR 3010230	80.00	70.00		15.114
FBR 2001074	80.00	3.00		0.648	FBR 3010375	81.00	23.00	1.70	5.023
FBR 2010200	80.00	4.00		0.863	FBR 2001051	82.00	9.00		1.990
FBR 2006163	80.00	5.00		1.079	FBR 2010184	85.00	16.00		3.671
FBR 2001092	80.00	5.50		1.180	FBR 3010292	87.00	82.00	2.00	19.252
FBR 2006028	80.00	6.00		1.296	FBR 2000221	88.00	4.00		0.949
FBR 3010178	80.00	8.00		1.727	FBR 2000167	88.00	4.70		1.108
FBR 2006071	80.00	8.00		1.727	FBR 3010235	88.90	9.50	4.75	2.227
FBR 3010234	80.00	8.00	1.00	1.725	FBR 3010315	88.90	12.70		3.047
FBR 2010216	80.00	8.00	4.00	1.690	FBR 3010179	90.00	10.00		2.429
FBR 2000122	80.00	10.00	1.50	2.150	FBR 3010348	90.00	12.00	1.00	2.913
FBR 2001050	80.00	10.00	3.00	2.160	FBR 3010000	90.00	15.00	7.50	3.510
FBR 2006029	80.00	10.00		2.160	FBR 3010028	90.00	15.00		3.644
FBR 2010047	80.00	10.00		2.160	FBR 3010016	90.00	20.00		4.859
FBR 2006165	80.00	10.00	5.00	2.102	FBR 2010158	90.00	20.00	10.00	4.628
FBR 2010157	80.00	10.00	5.00	2.102	FBR 3010100	90.00	25.00		6.074
FBR 2000190	80.00	12.00	1.00	2.592	FBR 3010102	90.00	30.00		7.289
FBR 2010080	80.00	12.00		2.592	FBR 3010040	90.00	40.00		9.719
FBR 2010175	80.00	12.00	6.00	2.508	FBR 3010101	90.00	50.00		12.149
FBR 3010224	80.00	12.50	1.00	2.697	FBR 3010285	90.00	50.00	25.00	10.701
FBR 2006041	80.00	15.00		3.239	FBR 3010041	90.00	60.00		14.579
FBR 2010066	80.00	15.00		3.239	FBR 3010115	90.70	19.00		4.652
FBR 2010207	80.00	16.00	8.00	3.307	FBR 2001054	91.00	5.30		1.302
FBR 2006184	80.00	20.00		4.319	FBR 3010404	92.00	63.00	1.00	15.648
FBR 2010067	80.00	20.00		4.319	FBR 2003891	93.30	5.50		1.385
FBR 3010014	80.00	25.00		5.399	FBR 3010309	95.00	35.50	1.50	9.100
FBR 3006185	80.00	30.00		6.479	FBR 3010191	96.00	14.00	1.00	3.626
FBR 3010092	80.00	35.00		7.559	FBR 2000155	100.00	2.00		0.540
FBR 3010187	80.00	40.00	6.00	8.124	FBR 1010265	100.00	3.00		0.809

BARS : FLAT

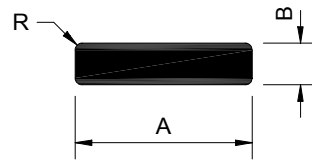

Section No	A	B	R	Kg/m	Section No	A	B	R	Kg/m
FBR 2006060	100.00	5.00		1.349	FBR 3010321	101.60	12.70	6.35	3.390
FBR 2006006	100.00	6.00		1.620	FBR 3010386	101.60	12.70	6.35	3.390
FBR 2010142	100.00	6.00		1.619	FBR 3006130	101.60	15.87		4.352
FBR 2006042	100.00	6.00		1.620	FBR 3010398	101.60	19.05	1.00	5.223
FBR 2006132	100.00	6.00	2.00	1.610	FBR 2006090	101.60	25.00	1.00	6.855
FBR 2006193	100.00	6.00	3.00	1.599	FBR 3006145	101.60	25.40		6.967
FBR 2006043	100.00	8.00		2.159	FBR 3010155	101.60	31.75		8.709
FBR 3010217	100.00	8.00	4.00	2.122	FBR 3010409	101.60	44.45	1.80	12.186
FBR 2000123	100.00	10.00	1.50	2.690	FBR 2001058	101.60	50.80		13.900
FBR 2000110	100.00	10.00	2.00	2.700	FBR 3010154	105.00	65.00		18.427
FBR 2006030	100.00	10.00		2.700	FBR 2001059	109.50	5.92		1.750
FBR 2006166	100.00	10.00	5.00	2.642	FBR 2010376	110.00	5.00	2.50	1.470
FBR 2010054	100.00	12.00		3.239	FBR 2006168	110.00	10.00	5.00	2.912
FBR 2006072	100.00	12.00		3.239	FBR 2001060	110.50	4.86		1.450
FBR 2000128	100.00	12.00	1.50	3.230	FBR 2010284	111.00	2.00		0.598
FBR 2010166	100.00	12.00	3.00	3.219	FBR 2010326	114.65	6.40	1.00	1.978
FBR 3010255	100.00	12.00	6.00	3.156	FBR 3010272	116.00	16.00	1.00	5.008
FBR 3010250	100.00	12.50	1.00	3.372	FBR 3010342	119.00	28.00		8.995
FBR 2006077	100.00	15.00		4.049	FBR 2010032	120.00	3.00	1.00	0.969
FBR 2006085	100.00	16.00		4.319	FBR 1010181	120.00	3.00		0.971
FBR 2010095	100.00	16.00	8.00	4.171	FBR 2006097	120.00	5.00		1.619
FBR 2000197	100.00	20.00		5.400	FBR 3010201	120.00	6.00		1.943
FBR 2006031	100.00	20.00		5.400	FBR 2010244	120.00	6.00	3.00	1.923
FBR 2006004	100.00	25.00		6.749	FBR 2006078	120.00	8.00		2.591
FBR 3010081	100.00	25.00		6.749	FBR 3010218	120.00	8.00	4.00	2.554
FBR 2001078	100.00	30.00		8.100	FBR 2001079	120.00	10.00		3.240
FBR 2010048	100.00	30.00		8.099	FBR 2000125	120.00	10.00	1.50	3.230
FBR 3010098	100.00	35.00		9.449	FBR 2006032	120.00	10.00		3.239
FBR 3010058	100.00	40.00		10.799	FBR 2010069	120.00	10.00		3.239
FBR 3010042	100.00	50.00		13.499	FBR 2006167	120.00	10.00	5.00	3.182
FBR 3010411	100.00	60.00	1.80	16.192	FBR 2010077	120.00	12.00		3.887
FBR 3010354	100.00	75.00	2.00	20.240	FBR 3010219	120.00	12.00	6.00	3.804
FBR 3010262	100.00	80.00	1.00	21.597	FBR 2006064	120.00	15.00		4.859
FBR 2010229	101.60	4.76	1.00	1.303	FBR 3006186	120.00	20.00		6.479
FBR 2001056	101.60	6.40		1.750	FBR 3010049	120.00	20.00		6.479
FBR 3010320	101.60	9.50	4.75	2.553	FBR 3006187	120.00	25.00		8.099
FBR 2006136	101.60	9.52		2.610	FBR 3010035	120.00	30.00		9.719
FBR 2001057	101.60	12.70		3.480	FBR 2001063	120.00	40.00		12.960

BARS : FLAT

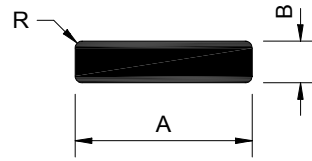

Section No	A	B	R	Kg/m	Section No	A	B	R	Kg/m
FBR 3010050	120.00	40.00		12.959	FBR 2000165	147.00	2.90		1.151
FBR 3010327	120.00	60.00	1.50	19.434	FBR 2000156	150.00	3.00		1.200
FBR 3010356	120.00	65.00	2.00	21.050	FBR 2010268	150.00	3.70	1.85	1.490
FBR 2001077	121.00	21.00		6.900	FBR 2006003	150.00	6.00		2.429
FBR 2010349	125.00	5.00	1.50	1.682	FBR 2006131	150.00	6.00	2.00	2.420
FBR 2006157	125.00	6.00	3.00	2.004	FBR 2006195	150.00	6.00	3.00	2.409
FBR 2000219	125.00	10.00	1.50	3.375	FBR 3006189	150.00	8.00		3.239
FBR 2000129	125.00	12.00	1.50	4.044	FBR 3010109	150.00	8.00		3.239
FBR 2003850	125.00	12.50		4.218	FBR 2000168	150.00	10.00	1.50	4.040
FBR 1010136	127.00	2.00		0.658	FBR 2006033	150.00	10.00		4.049
FBR 2000183	127.00	6.35		2.177	FBR 3006174	150.00	10.00	5.00	3.992
FBR 3010319	127.00	9.50	4.75	3.205	FBR 2006001	150.00	12.00	6.00	4.776
FBR 3010148	127.00	9.53		3.267	FBR 3010052	150.00	12.00		4.859
FBR 3010149	127.00	15.87		5.441	FBR 3006149	150.00	12.20		4.941
FBR 3010150	127.00	19.05		6.532	FBR 3010242	150.00	12.50	1.50	5.057
FBR 3010170	127.00	25.40	1.00	8.707	FBR 2006065	150.00	15.00		6.074
FBR 3010237	127.00	32.00	1.80	10.965	FBR 3010256	150.00	15.00	7.50	5.944
FBR 3010161	127.00	38.00		13.030	FBR 2000188	150.00	16.00	1.00	6.480
FBR 3010164	127.00	40.00		13.715	FBR 3006188	150.00	20.00		8.099
FBR 3010168	127.00	50.80	1.00	17.417	FBR 3010127	150.00	22.00		8.909
FBR 3010153	130.00	65.00		22.815	FBR 3010394	150.00	25.00	1.00	10.122
FBR 2000220	133.00	4.00		1.435	FBR 3010093	150.00	30.00		12.149
FBR 2003893	133.00	5.50		1.975	FBR 3010412	150.00	40.00	1.80	16.192
FBR 3010344	133.00	53.00	3.00	19.011	FBR 2010057	151.00	3.60		1.467
FBR 2010194	140.00	6.00	3.00	2.247	FBR 3010160	151.00	40.00		16.308
FBR 3006173	140.00	10.00	5.00	3.722	FBR 3010165	152.00	32.00		13.132
FBR 3010125	140.00	10.00		3.779	FBR 3010211	152.00	50.80	1.00	20.846
FBR 3006110	140.00	12.00	1.00	4.533	FBR 2001067	152.40	6.35		2.612
FBR 3010180	140.00	15.00	1.00	5.667	FBR 3010317	152.40	9.50	4.75	3.856
FBR 3010043	140.00	20.00		7.559	FBR 3010227	152.40	9.52	1.50	3.912
FBR 3010251	140.00	22.00	1.00	8.313	FBR 3010389	152.40	9.53	4.76	3.868
FBR 3010044	140.00	40.00		15.119	FBR 2001068	152.40	12.70		5.225
FBR 2000164	142.00	2.90		1.111	FBR 3010387	152.40	12.70	6.35	5.132
FBR 3010266	142.00	16.00	1.00	6.132	FBR 2006034	152.40	25.40		10.451
FBR 3010359	143.00	48.00	3.00	18.511	FBR 3010388	152.40	25.40	12.70	10.077
FBR 3010110	145.00	13.00		5.089	FBR 3010261	152.50	50.80	1.00	20.914
FBR 2000195	146.00	2.90		1.143	FBR 2010176	153.00	3.60		1.486
FBR 2010283	146.00	3.00		1.182	FBR 3010246	155.00	50.00		20.924

BARS : FLAT

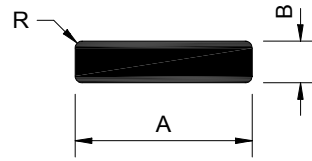

Section No	A	B	R	Kg/m	Section No	A	B	R	Kg/m
FBR 2010350	160.00	5.00	1.50	2.154	FBR 2006197	200.00	6.00	3.00	3.219
FBR 3006156	160.00	6.00		2.591	FBR 3010258	200.00	6.00	3.00	3.219
FBR 3000124	160.00	10.00	1.50	4.310	FBR 3010033	200.00	8.00	1.00	4.317
FBR 3010082	160.00	10.00		4.320	FBR 3010162	200.00	10.00	1.00	5.397
FBR 3010220	160.00	10.00	5.00	4.262	FBR 2006009	200.00	10.00	5.00	5.342
FBR 3006155	160.00	12.50		5.400	FBR 3006098	200.00	10.00		5.399
FBR 3010221	160.00	14.00	7.00	5.934	FBR 3006200	200.00	12.00	1.00	6.477
FBR 3006199	160.00	16.00		6.911	FBR 3010299	200.00	12.00	3.00	6.459
FBR 3010108	160.00	20.00		8.639	FBR 3000198	200.00	12.00	6.00	6.396
FBR 3010407	160.00	55.00	2.50	23.745	FBR 3006083	200.00	15.00		8.099
FBR 3010363	161.00	6.35	0.80	2.758	FBR 3006086	200.00	16.00	1.00	8.637
FBR 3010188	162.00	25.40	1.00	11.107	FBR 3006102	200.00	20.00	1.00	10.797
FBR 3006162	170.00	12.00	3.00	5.487	FBR 3006087	200.00	25.00	1.00	13.497
FBR 3006161	170.00	20.00	3.00	9.156	FBR 3010163	200.00	40.00		21.599
FBR 2010119	172.00	2.80		1.299	FBR 3010361	200.00	43.00	0.50	23.219
FBR 2000187	172.00	2.95		1.369	FBR 3010113	200.00	50.00		27.000
FBR 2000231	175.00	5.00		2.361	FBR 3010130	203.00	6.35	3.18	3.457
FBR 2010365	175.00	5.00	2.50	2.348	FBR 3010117	203.00	25.40		13.921
FBR 2006196	175.00	6.00	3.00	2.814	FBR 3010264	203.00	32.00	1.00	17.536
FBR 2010193	175.00	6.00	3.00	2.814	FBR 3010362	203.00	36.00	1.00	19.729
FBR 3010276	175.00	6.00	3.00	2.841	FBR 3010390	203.20	9.53	4.76	5.175
FBR 3010358	175.00	8.00	1.00	3.777	FBR 3006175	203.20	12.70	2.00	6.958
FBR 3010248	175.00	12.00	6.00	5.586	FBR 3010330	210.00	6.00	3.00	3.381
FBR 3010249	175.00	15.00	7.50	6.957	FBR 3010331	210.00	12.00	6.00	6.720
FBR 3010112	176.00	16.00		7.603	FBR 3010126	220.00	20.00		11.879
FBR 3010263	176.00	25.40	1.00	12.060	FBR 3010414	222.00	32.00	2.00	19.171
FBR 3010171	176.00	32.00	1.00	15.204	FBR 3010231	225.00	4.00	1.00	2.427
FBR 3010159	176.00	38.00		18.057	FBR 3010129	225.00	14.00	1.50	8.504
FBR 3010328	176.00	50.80	1.50	24.134	FBR 3010210	225.00	16.00	1.00	9.717
FBR 2010245	160.00	6.00	3.00	2.571	FBR 3010298	225.00	45.00	1.50	27.333
FBR 2006005	180.00	10.00	1.00	4.857	FBR 3010343	225.50	20.00		12.176
FBR 3010282	180.00	10.50	1.00	5.100	FBR 3010114	229.00	19.00		11.747
FBR 3010128	180.00	16.00		7.775	FBR 3010111	235.00	17.50	4.00	11.060
FBR 3010228	180.00	12.50	3.00	6.054	FBR 3010192	240.00	6.00	3.00	3.867
FBR 2010196	185.00	6.00	3.00	2.976	FBR 3010275	240.00	6.00	3.00	3.867
FBR 3010271	185.00	23.00	1.00	11.486	FBR 3010293	244.40	12.70	0.80	8.378
FBR 3010045	190.00	15.00		7.694	FBR 3010212	250.00	20.00	1.00	13.500
FBR 3006151	192.00	13.50	2.00	6.989	FBR 3010408	265.00	16.00	1.50	11.442

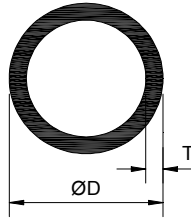
TUBES : ROUND

Section No	D	T	Kg/m
RTU 1020163	7.40	1.45	0.073
RTU 1020217	8.30	1.38	0.080
RTU 1020172	8.80	1.85	0.109
RTU 1020193	9.20	2.00	0.122
RTU 1000284	9.70	1.35	0.095
RTU 1006702	10.00	1.25	0.092
RTU 2000287	10.00	1.50	0.108
RTU 1000381	10.00	1.50	0.108
RTU 1020194	10.40	2.00	0.142
RTU 1000242	10.80	1.40	0.110
RTU 1000382	10.80	1.40	0.111
RTU 1020165	10.80	1.33	0.106
RTU 1006986	11.10	1.40	0.115
RTU 1020232	11.90	2.60	0.205
RTU 1000357	12.00	1.00	0.093
RTU 1006921	12.00	1.00	0.093
RTU 1020265	12.00	2.00	0.169
RTU 1020195	12.00	2.20	0.182
RTU 1020027	12.20	2.60	0.211
RTU 1006908	12.30	1.10	0.104
RTU 1001162	12.70	1.30	0.127
RTU 1020246	13.00	1.50	0.146
RTU 1000288	13.00	1.85	0.174
RTU 1000383	13.00	1.85	0.174
RTU 1006987	13.50	1.70	0.170
RTU 1020233	13.50	2.85	0.257
RTU 1006750	13.60	2.00	0.196
RTU 1020196	14.00	2.40	0.236
RTU 2020021	14.00	3.25	0.296
RTU 1006701	14.50	1.45	0.160
RTU 1020162	14.50	2.10	0.220
RTU 1006635	14.50	2.90	0.285
RTU 1000294	15.10	1.20	0.141
RTU 1020040	15.60	2.15	0.245
RTU 1020197	15.60	2.50	0.277
RTU 2000250	15.70	2.05	0.237
RTU 1006881	16.00	1.00	0.127
RTU 1002018	16.00	1.50	0.184

Section No	D	T	Kg/m
RTU 1006789	16.00	1.50	0.184
RTU 2001166	16.00	2.00	0.235
RTU 1000384	16.00	2.20	0.257
RTU 1006618	16.00	3.00	0.330
RTU 1020029	16.20	3.15	0.348
RTU 1020059	16.25	3.03	0.339
RTU 1020164	16.25	3.40	0.370
RTU 1020011	16.70	2.30	0.280
RTU 2020216	16.80	5.40	0.522
RTU 1020117	16.90	2.45	0.300
RTU 1000243	17.00	2.10	0.265
RTU 2000394	17.00	2.60	0.317
RTU 1000385	17.10	2.10	0.267
RTU 1006627	17.40	2.10	0.273
RTU 1020060	17.40	3.05	0.371
RTU 1002007	18.00	1.20	0.190
RTU 1020198	18.00	2.60	0.339
RTU 1020098	18.50	1.20	0.176
RTU 2006609	18.50	3.00	0.394
RTU 2020101	18.50	3.65	0.459
RTU 1020079	18.50	3.75	0.469
RTU 2020212	18.80	6.10	0.657
RTU 1020123	18.90	1.20	0.180
RTU 1001171	19.00	1.20	0.180
RTU 1020118	19.00	2.65	0.367
RTU 2006711	19.00	3.75	0.485
RTU 1002014	19.05	1.00	0.153
RTU 1001169	19.05	1.00	0.153
RTU 1020071	19.05	1.20	0.181
RTU 1020072	19.05	1.40	0.209
RTU 2006727	19.05	1.60	0.236
RTU 1020086	19.05	1.70	0.250
RTU 1000325	19.05	2.03	0.295
RTU 1000295	19.10	1.00	0.132
RTU 1020061	19.30	3.50	0.469
RTU 2006833	19.30	3.80	0.500
RTU 1006704	19.50	1.45	0.222
RTU 1002019	19.50	1.50	0.229

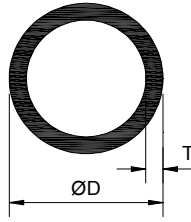
TUBES : ROUND

Section No	D	T	Kg/m
RTU 2000244	19.50	2.35	0.337
RTU 2000380	19.50	4.25	0.549
RTU 2006896	19.60	2.00	0.298
RTU 2006988	19.60	2.30	0.337
RTU 2000386	19.60	2.40	0.350
RTU 1020199	19.70	2.70	0.389
RTU 1006978	20.00	1.00	0.161
RTU 1006977	20.00	1.20	0.191
RTU 1020006	20.00	1.50	0.235
RTU 2006664	20.00	2.00	0.305
RTU 2006922	20.00	3.00	0.432
RTU 2020091	20.00	4.00	0.542
RTU 2006876	20.00	5.00	0.636
RTU 2020143	20.00	5.50	0.676
RTU 1000292	20.60	1.45	0.235
RTU 2006649	21.00	2.50	0.392
RTU 2020187	21.00	2.50	0.392
RTU 2020166	21.00	3.00	0.458
RTU 2006890	21.00	4.75	0.654
RTU 1020140	21.10	2.90	0.447
RTU 1020261	21.10	3.00	0.460
RTU 1020089	21.18	1.60	0.265
RTU 2000245	21.20	2.45	0.402
RTU 1020225	21.20	2.55	0.403
RTU 2006934	21.20	2.60	0.410
RTU 2020175	21.30	3.65	0.546
RTU 2006989	21.50	2.50	0.402
RTU 1020030	21.70	2.70	0.435
RTU 2000395	21.90	3.15	0.500
RTU 1001173	22.00	1.00	0.178
RTU 1006700	22.00	1.05	0.186
RTU 1020237	22.00	1.80	0.308
RTU 2006818	22.00	2.00	0.339
RTU 2000396	22.00	2.75	0.449
RTU 1020200	22.00	2.90	0.469
RTU 2006762	22.00	4.00	0.610
RTU 2006776	22.00	5.25	0.745
RTU 2000333	22.00	5.75	0.792

Section No	D	T	Kg/m
RTU 1020215	22.20	4.15	0.635
RTU 2020022	22.20	4.40	0.664
RTU 1020070	22.22	1.20	0.213
RTU 1020073	22.22	1.40	0.247
RTU 1020088	22.22	1.60	0.279
RTU 2020250	22.23	2.91	0.477
RTU 2020159	22.25	4.93	0.723
RTU 1020014	23.00	3.95	0.638
RTU 2020102	23.00	4.15	0.663
RTU 3006964	23.00	5.00	0.763
RTU 2020000	23.20	2.70	0.469
RTU 2020158	23.25	4.18	0.675
RTU 2006650	23.60	2.85	0.501
RTU 2020077	23.50	5.68	0.858
RTU 2000254	23.70	2.85	0.503
RTU 2006935	23.70	2.85	0.503
RTU 2020119	23.90	3.65	0.626
RTU 1006658	24.00	1.90	0.356
RTU 2006948	24.00	2.00	0.373
RTU 1000389	24.00	2.70	0.495
RTU 1020253	24.00	2.75	0.495
RTU 1020201	24.00	3.10	0.549
RTU 2020052	24.00	5.85	0.900
RTU 2020053	24.00	6.45	0.960
RTU 2006705	24.80	7.85	1.128
RTU 1001175	25.00	1.00	0.200
RTU 1006632	25.00	1.20	0.242
RTU 2000251	25.00	1.25	0.250
RTU 2001176	25.00	1.50	0.300
RTU 2002015	25.00	1.50	0.335
RTU 1020263	25.00	1.50	0.300
RTU 1006694	25.00	2.00	0.390
RTU 1006642	25.00	2.50	0.477
RTU 2020124	25.00	2.35	0.451
RTU 2006684	25.00	3.00	0.559
RTU 2020234	25.00	4.00	0.712
RTU 2006693	25.00	4.75	0.815
RTU 3006874	25.00	5.00	0.848

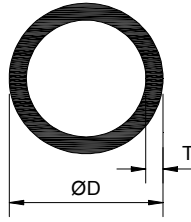
TUBES : ROUND

Section No	D	T	Kg/m
RTU 2006633	25.00	5.75	0.939
RTU 2000362	25.00	6.00	0.996
RTU 3006883	25.00	7.13	1.080
RTU 2000312	25.00	7.50	1.113
RTU 1006747	25.10	1.25	0.253
RTU 2000346	25.20	3.20	0.602
RTU 2020023	25.20	4.35	0.769
RTU 2020161	25.25	4.38	0.774
RTU 1002001	25.40	1.00	0.237
RTU 1020066	25.40	1.20	0.246
RTU 1020087	25.40	1.30	0.266
RTU 1000274	25.40	1.58	0.319
RTU 2000252	25.40	1.60	0.322
RTU 1020090	25.40	1.60	0.322
RTU 2000278	25.40	3.20	0.605
RTU 2020285	25.40	6.35	1.026
RTU 2020138	25.50	6.25	1.020
RTU 1020219	25.70	4.60	0.823
RTU 2020191	25.70	6.70	1.079
RTU 2006687	26.00	4.50	0.820
RTU 3006841	26.00	6.85	1.112
RTU 2020128	26.00	7.95	1.217
RTU 2020151	26.50	4.10	0.779
RTU 1020036	26.70	3.50	0.688
RTU 1006699	27.00	1.05	0.231
RTU 2006952	27.00	2.00	0.424
RTU 2006897	27.00	3.20	0.646
RTU 2020001	27.00	3.00	0.610
RTU 2020055	27.00	3.50	0.697
RTU 2006802	27.00	4.00	0.780
RTU 2020012	27.00	6.15	1.087
RTU 2020120	27.20	3.95	0.778
RTU 1020004	27.70	4.00	0.804
RTU 1020211	27.70	5.60	1.049
RTU 1000290	28.00	1.20	0.270
RTU 2002008	28.00	1.50	0.360
RTU 2002017	28.00	2.00	0.440
RTU 2006936	28.00	3.00	0.636

Section No	D	T	Kg/m
RTU 2020157	28.05	3.50	0.728
RTU 2000302	28.15	3.68	0.762
RTU 2000303	28.15	7.18	1.275
RTU 2020202	28.20	4.00	0.821
RTU 1020015	28.20	4.95	0.976
RTU 2020174	28.40	5.05	1.000
RTU 2020168	28.50	5.00	0.996
RTU 1000305	28.60	1.60	0.360
RTU 2000249	28.60	3.30	0.707
RTU 2020160	28.75	5.13	1.027
RTU 2006652	28.80	8.30	1.443
RTU 2020134	28.80	7.30	1.331
RTU 3006966	29.00	5.50	1.096
RTU 1006637	29.30	1.00	0.240
RTU 1020097	29.30	4.80	0.997
RTU 2020020	29.50	2.85	0.644
RTU 2000246	30.00	1.10	0.265
RTU 1006603	30.00	1.25	0.304
RTU 1020009	30.00	1.50	0.362
RTU 2006678	30.00	2.00	0.475
RTU 1006643	30.00	2.50	0.583
RTU 1006601	30.00	2.60	0.604
RTU 1006629	30.00	3.00	0.687
RTU 2006757	30.00	3.00	0.687
RTU 2006891	30.00	4.00	0.883
RTU 2006695	30.00	5.00	1.060
RTU 2020069	30.00	6.50	1.295
RTU 3020109	30.00	7.50	1.431
RTU 2001198	30.00	6.90	1.350
RTU 3020082	30.00	8.85	1.587
RTU 1020142	30.20	4.05	0.898
RTU 2020002	30.20	4.20	0.926
RTU 2006766	30.20	5.45	1.144
RTU 2020116	30.30	2.00	0.480
RTU 2006686	30.50	5.50	1.166
RTU 2000397	31.00	3.50	0.816
RTU 2006937	31.00	3.50	0.816
RTU 2000283	31.00	7.38	1.480

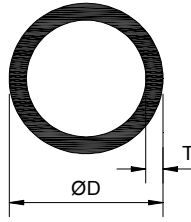
TUBES : ROUND

Section No	D	T	Kg/m	Section No	D	T	Kg/m
RTU 1020035	31.10	3.75	0.869	RTU 2020005	34.20	4.10	1.046
RTU 2020145	31.20	4.70	1.056	RTU 2020024	34.20	5.35	1.309
RTU 2020286	31.75	3.25	0.785	RTU 2006607	34.50	3.75	0.978
RTU 2006919	31.80	4.50	1.042	RTU 2020121	34.80	4.90	1.242
RTU 1006698	32.00	1.05	0.275	RTU 1006676	35.00	1.30	0.371
RTU 1000268	32.00	1.20	0.320	RTU 2006717	35.00	2.00	0.559
RTU 1006956	32.00	1.50	0.388	RTU 3006726	35.00	2.50	0.689
RTU 2001191	32.00	1.70	0.436	RTU 2000310	35.00	3.00	0.813
RTU 2002016	32.00	1.70	0.500	RTU 2006998	35.00	4.00	1.051
RTU 1006959	32.00	2.00	0.508	RTU 2006918	35.00	4.50	1.164
RTU 2006680	32.00	3.00	0.737	RTU 2006656	35.00	5.00	1.272
RTU 2000255	32.00	3.50	0.845	RTU 2006947	35.20	4.50	1.171
RTU 2020083	32.00	4.00	0.950	RTU 3020110	35.30	9.15	2.029
RTU 3006894	32.00	4.50	1.049	RTU 3020111	35.30	10.15	2.165
RTU 2006904	32.00	4.50	1.049	RTU 1006782	35.50	1.75	0.500
RTU 2006878	32.00	5.00	1.145	RTU 2020254	35.50	4.30	1.137
RTU 2020218	32.00	5.50	1.236	RTU 2006628	35.50	4.35	1.149
RTU 2006647	32.00	6.00	1.323	RTU 2006636	35.50	4.70	1.227
RTU 2006691	32.00	6.25	1.365	RTU 1006631	35.80	2.00	0.573
RTU 2020141	32.00	7.50	1.558	RTU 1006608	36.00	1.00	0.296
RTU 2020025	32.20	5.20	1.190	RTU 1000304	36.00	2.00	0.580
RTU 2000258	32.50	9.00	1.793	RTU 1006859	36.00	2.00	0.576
RTU 2000264	33.00	2.75	0.765	RTU 1000271	36.00	4.00	1.090
RTU 2006725	33.00	3.00	0.763	RTU 2006858	36.00	4.00	1.085
RTU 3006928	33.00	5.50	1.282	RTU 2006938	36.00	4.00	1.085
RTU 2006718	33.00	6.20	1.409	RTU 2006663	36.00	6.00	1.526
RTU 2020173	33.00	9.20	1.857	RTU 3006953	36.00	6.25	1.577
RTU 2006692	33.40	5.86	1.367	RTU 3006972	36.00	6.75	1.674
RTU 2020129	33.40	3.38	0.860	RTU 3006871	36.00	13.00	2.536
RTU 2002005	33.50	4.00	1.050	RTU 2006877	36.20	5.00	1.323
RTU 2006990	33.50	4.75	1.158	RTU 2006768	36.60	6.60	1.679
RTU 2006767	33.50	6.10	1.417	RTU 3020209	37.00	6.25	1.630
RTU 1020010	34.00	1.50	0.413	RTU 3020301	37.00	12.25	2.571
RTU 2006729	34.00	2.00	0.542	RTU 2000377	37.15	8.68	2.095
RTU 1020236	34.00	4.50	1.126	RTU 2000368	37.30	1.60	0.484
RTU 2020026	34.00	4.75	1.178	RTU 2020180	37.30	5.55	1.494
RTU 2020080	34.00	5.50	1.329	RTU 2000367	37.50	4.25	1.218
RTU 2020203	34.00	6.25	1.471	RTU 1001177	38.00	1.20	0.370

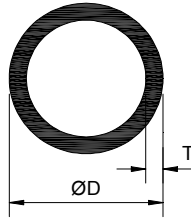
TUBES : ROUND

Section No	D	T	Kg/m
RTU 2001207	38.00	1.95	0.580
RTU 2002004	38.00	2.00	0.610
RTU 2020042	38.00	2.60	0.780
RTU 1006797	38.00	3.00	0.890
RTU 2000363	38.00	3.15	0.930
RTU 2001178	38.00	4.00	1.160
RTU 3006882	38.00	5.00	1.399
RTU 2000282	38.00	6.00	1.620
RTU 2000398	38.00	6.75	1.789
RTU 2006991	38.00	7.00	1.840
RTU 2001179	38.00	7.50	1.930
RTU 3020148	38.00	7.50	1.940
RTU 3006920	38.00	7.90	2.017
RTU 2000360	38.00	12.00	2.645
RTU 1002002	38.10	1.40	0.460
RTU 2000263	38.20	1.60	0.500
RTU 3020167	38.50	6.75	1.817
RTU 2020034	39.00	5.00	1.441
RTU 1020204	39.10	5.35	1.531
RTU 2006721	39.80	9.40	2.422
RTU 2000364	40.00	1.80	0.582
RTU 1006709	40.00	2.00	0.644
RTU 2001183	40.00	2.50	0.790
RTU 1006644	40.00	2.50	0.795
RTU 2006696	40.00	3.00	0.941
RTU 2006786	40.00	4.00	1.221
RTU 2006795	40.00	4.50	1.355
RTU 2006645	40.00	5.00	1.484
RTU 2006827	40.00	6.00	1.730
RTU 3006909	40.00	6.75	1.903
RTU 3006879	40.00	7.50	2.067
RTU 2000247	40.00	8.50	2.271
RTU 2006829	40.00	10.00	2.544
RTU 1006860	40.10	2.50	0.797
RTU 2020062	40.50	7.15	2.022
RTU 2006769	40.60	7.25	2.050
RTU 2020043	41.00	5.00	1.526
RTU 2006939	41.00	5.50	1.656

Section No	D	T	Kg/m
RTU 3006951	41.00	9.50	2.538
RTU 2000257	41.90	2.00	0.680
RTU 2006719	42.00	3.00	0.992
RTU 2020287	42.00	5.00	1.569
RTU 2000314	42.00	11.50	2.973
RTU 2020076	42.00	12.00	3.053
RTU 3020064	42.16	3.55	1.162
RTU 3020063	42.16	4.85	1.534
RTU 2000344	42.30	2.60	0.875
RTU 1020100	42.50	2.45	0.832
RTU 3020183	42.50	7.00	2.107
RTU 2020144	42.70	3.85	1.268
RTU 1020078	43.00	1.70	0.595
RTU 3006929	43.00	6.00	1.883
RTU 3020208	43.00	8.25	2.431
RTU 2006740	43.00	10.00	2.799
RTU 1020045	43.20	2.50	0.863
RTU 3006996	43.20	12.35	3.231
RTU 1006783	43.50	1.75	0.619
RTU 2000309	43.50	8.00	2.407
RTU 1000275	43.80	2.00	0.709
RTU 2006949	44.00	7.50	2.322
RTU 2020122	44.40	6.35	2.049
RTU 2001194	44.50	2.00	0.720
RTU 2000279	44.50	3.25	1.130
RTU 2020095	44.70	6.50	2.106
RTU 1006763	44.80	1.90	0.619
RTU 1020231	45.00	2.00	0.729
RTU 2006621	45.00	2.50	0.901
RTU 2006787	45.00	5.00	1.696
RTU 3006868	45.00	5.50	1.842
RTU 3006975	45.00	7.50	2.385
RTU 3020057	45.00	13.50	3.607
RTU 2006736	45.45	2.725	0.999
RTU 2000318	46.00	5.00	1.738
RTU 2020184	46.00	5.00	1.738
RTU 2000289	46.00	5.50	1.880
RTU 2006940	46.00	5.50	1.889

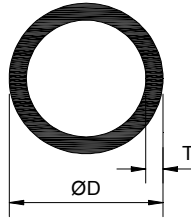
TUBES : ROUND

Section No	D	T	Kg/m
RTU 2020016	46.00	6.00	2.035
RTU 2020178	46.00	7.50	2.449
RTU 2000399	46.00	8.00	2.578
RTU 2006640	46.00	10.50	3.161
RTU 2020244	46.80	8.30	2.710
RTU 2006730	47.00	4.50	1.622
RTU 3020251	47.20	8.60	2.815
RTU 1006737	48.00	2.00	0.780
RTU 2006655	48.00	3.00	1.145
RTU 2006666	48.00	3.00	1.145
RTU 2020146	48.30	3.00	1.152
RTU 2002006	48.00	4.00	1.566
RTU 2001196	48.00	8.25	2.780
RTU 2006886	48.00	8.50	2.847
RTU 2006892	48.00	8.50	2.847
RTU 2000343	48.00	18.75	4.652
RTU 2000347	48.26	3.68	1.390
RTU 3006993	48.26	5.08	1.860
RTU 1006970	48.30	2.90	1.116
RTU 2002011	48.40	2.60	1.060
RTU 2020207	48.50	4.95	1.828
RTU 2020182	48.50	7.00	2.464
RTU 2020056	49.00	5.20	1.931
RTU 3006995	49.20	4.25	1.620
RTU 1006707	50.00	1.50	0.617
RTU 2000376	50.00	1.60	0.656
RTU 2006679	50.00	2.00	0.814
RTU 2006654	50.00	2.50	1.007
RTU 2006630	50.00	2.80	1.121
RTU 2006900	50.00	2.90	1.158
RTU 2006667	50.00	3.00	1.196
RTU 2020044	50.00	4.00	1.560
RTU 2000369	50.00	5.00	1.908
RTU 2006681	50.00	5.00	1.908
RTU 2006788	50.00	5.00	1.908
RTU 2006616	50.00	6.00	2.239
RTU 2006815	50.00	7.50	2.703
RTU 2000316	50.00	8.00	2.850

Section No	D	T	Kg/m
RTU 3006842	50.00	8.00	2.850
RTU 3006944	50.00	9.00	3.129
RTU 2006714	50.00	10.00	3.392
RTU 2000379	50.00	10.10	3.418
RTU 3006969	50.00	10.50	3.518
RTU 2006823	50.00	11.00	3.638
RTU 3020247	50.00	11.00	3.638
RTU 3020058	50.00	15.00	4.453
RTU 2000261	50.20	2.00	0.815
RTU 3020188	50.20	8.00	2.863
RTU 3020149	50.50	8.75	3.098
RTU 2000315	50.50	12.75	4.082
RTU 2002009	50.80	1.63	0.730
RTU 2002003	50.80	1.80	0.780
RTU 2002010	50.80	2.64	1.140
RTU 2001201	50.80	3.15	1.270
RTU 2020302	50.80	4.76	1.858
RTU 2006742	50.80	14.40	4.446
RTU 2006710	51.00	2.00	0.832
RTU 2001209	51.00	6.00	2.290
RTU 2020185	51.00	6.00	2.290
RTU 3020068	51.00	9.00	3.206
RTU 3020177	51.00	11.50	3.853
RTU 2006668	51.00	12.50	4.033
RTU 2001202	51.20	3.60	1.530
RTU 3020096	52.00	6.00	2.341
RTU 3020017	52.00	7.00	2.671
RTU 2000253	52.00	12.00	4.100
RTU 2006659	53.00	14.00	4.631
RTU 1006784	53.50	1.75	0.768
RTU 3020150	54.00	9.50	3.585
RTU 3006926	54.00	9.75	3.659
RTU 2001208	54.00	10.00	3.730
RTU 2006895	54.00	10.00	3.732
RTU 2006902	54.00	10.00	3.732
RTU 3020067	54.00	10.50	3.874
RTU 2001200	55.00	2.50	1.110
RTU 2006917	55.00	2.50	1.113

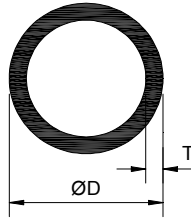
TUBES : ROUND

Section No	D	T	Kg/m
RTU 2006821	55.00	5.00	2.120
RTU 3006885	55.00	7.50	3.021
RTU 3006994	55.00	8.00	3.189
RTU 2006670	55.00	8.00	3.189
RTU 2000348	55.00	10.00	3.815
RTU 3020290	55.00	10.00	3.817
RTU 3020192	55.50	16.00	5.360
RTU 2006622	56.00	3.00	1.349
RTU 2020081	56.00	7.50	3.085
RTU 3006927	56.00	10.75	4.126
RTU 3006943	56.00	12.25	4.545
RTU 3006825	56.00	17.50	5.714
RTU 1020092	57.00	2.50	1.155
RTU 2000358	57.00	6.75	2.875
RTU 2006660	57.15	3.17	1.451
RTU 3006910	57.50	9.00	3.702
RTU 2006903	58.40	10.50	4.266
RTU 2006626	58.50	9.60	3.981
RTU 2006639	58.80	4.00	1.860
RTU 1020093	59.00	2.50	1.198
RTU 2000265	59.00	11.25	4.556
RTU 2000317	60.00	1.50	0.744
RTU 2000390	60.00	2.00	0.983
RTU 1006925	60.00	2.00	0.983
RTU 2000354	60.00	2.50	1.210
RTU 2006720	60.00	2.50	1.219
RTU 2006905	60.00	2.50	1.219
RTU 2006916	60.00	2.50	1.219
RTU 2006697	60.00	3.00	1.450
RTU 2001190	60.00	4.00	1.900
RTU 2006682	60.00	5.00	2.332
RTU 2006834	60.00	5.00	2.332
RTU 2006731	60.00	5.50	2.542
RTU 2000361	60.00	6.00	2.746
RTU 2020075	60.00	6.00	2.748
RTU 3006880	60.00	7.50	3.339
RTU 2006830	60.00	8.00	3.528
RTU 2006800	60.00	10.00	4.241

Section No	D	T	Kg/m
RTU 2000355	60.00	14.00	5.459
RTU 2006828	60.00	15.00	5.725
RTU 3006798	60.00	18.00	6.412
RTU 2006809	60.00	20.00	6.785
RTU 2006662	60.30	3.91	1.869
RTU 2006657	60.30	5.40	2.514
RTU 2001210	60.50	6.00	2.770
RTU 2006954	60.60	4.20	2.009
RTU 2006672	61.00	9.00	3.969
RTU 2006671	61.00	11.00	4.665
RTU 3020252	61.20	13.85	5.562
RTU 3020112	62.00	14.00	5.700
RTU 3020099	62.00	15.25	6.047
RTU 2020046	62.10	2.40	1.215
RTU 2006669	62.50	13.50	5.611
RTU 2000262	62.50	21.50	7.470
RTU 3020147	62.80	6.00	2.890
RTU 2006796	63.00	3.50	1.766
RTU 2020206	63.00	4.00	2.001
RTU 2001182	63.00	5.00	2.458
RTU 2001197	63.00	8.00	3.725
RTU 3020003	63.00	10.00	4.495
RTU 3020106	63.00	16.50	6.508
RTU 1006832	63.50	1.65	0.865
RTU 1020130	63.50	1.65	0.865
RTU 2000378	63.50	3.20	1.635
RTU 3020039	63.50	6.75	3.249
RTU 3006911	63.50	8.50	3.965
RTU 3006984	63.50	13.25	5.647
RTU 2006615	64.00	6.00	2.951
RTU 2000327	64.00	11.00	4.945
RTU 2000345	64.00	15.50	6.376
RTU 2006941	65.00	2.50	1.325
RTU 3006999	65.00	5.00	2.544
RTU 2006835	65.00	7.50	3.658
RTU 2006799	65.00	10.00	4.662
RTU 3006792	65.00	15.00	6.361
RTU 2006606	65.00	18.75	7.355

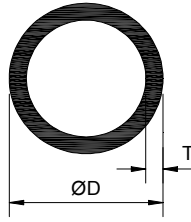
TUBES : ROUND

Section No	D	T	Kg/m
RTU 2000308	65.00	20.00	7.630
RTU 1020152	67.00	2.00	1.102
RTU 3006906	67.00	18.40	7.585
RTU 2000306	67.00	21.00	8.190
RTU 2006785	67.60	2.30	1.273
RTU 2006605	67.60	2.50	1.380
RTU 1020135	68.00	2.00	1.119
RTU 3020018	68.50	7.50	3.880
RTU 2006728	68.60	2.70	1.509
RTU 2001181	68.60	5.30	2.840
RTU 2020047	68.70	2.55	1.430
RTU 2006932	69.00	2.00	1.136
RTU 2006623	69.00	3.00	1.680
RTU 1020131	69.85	1.65	0.954
RTU 1020115	70.00	1.60	0.928
RTU 2006790	70.00	3.50	1.974
RTU 2006685	70.00	5.00	2.756
RTU 3006760	70.00	5.00	2.756
RTU 2006803	70.00	5.00	2.756
RTU 2006801	70.00	7.00	3.740
RTU 3006923	70.00	7.50	3.976
RTU 2000272	70.00	8.00	4.207
RTU 3006758	70.00	10.00	5.089
RTU 2006613	70.00	12.50	6.093
RTU 3006814	70.00	12.50	6.093
RTU 2006722	70.00	13.50	6.469
RTU 3006804	70.00	15.00	6.997
RTU 3006838	70.00	20.00	8.482
RTU 3020125	70.50	25.25	9.691
RTU 2000359	72.00	6.00	3.357
RTU 3020107	72.00	11.00	5.691
RTU 2000372	72.00	27.00	10.305
RTU 2000338	72.50	3.50	2.050
RTU 2000352	73.00	2.00	1.203
RTU 2020013	73.00	2.25	1.350
RTU 2006753	73.00	4.50	2.614
RTU 3006889	73.00	6.00	3.409
RTU 2006746	73.00	7.01	3.923

Section No	D	T	Kg/m
RTU 3006862	73.02	7.01	4.237
RTU 3006967	73.03	5.16	2.970
RTU 2000276	73.20	5.30	3.050
RTU 2006931	75.00	2.00	1.238
RTU 2006893	75.00	2.50	1.537
RTU 2006901	75.00	2.50	1.537
RTU 3020291	75.00	7.00	4.037
RTU 3006974	75.00	10.00	5.513
RTU 3006950	75.00	12.50	6.626
RTU 3006839	75.00	15.00	7.634
RTU 2006612	75.00	27.50	11.080
RTU 3006912	75.50	8.75	4.954
RTU 1006981	76.00	1.60	0.996
RTU 2020041	76.00	2.50	1.556
RTU 2020037	76.00	3.00	1.857
RTU 2020074	76.00	4.00	2.442
RTU 2000277	76.00	6.00	3.560
RTU 3020228	76.00	23.00	10.339
RTU 2001246	76.20	1.27	0.805
RTU 1020132	76.20	1.65	1.043
RTU 3006853	76.20	3.04	1.886
RTU 3006852	76.20	3.81	2.339
RTU 3006855	76.20	4.76	2.884
RTU 3006856	76.20	5.08	3.064
RTU 3006861	76.20	9.50	5.374
RTU 2000341	76.50	3.00	1.869
RTU 2000313	76.50	13.75	7.318
RTU 2006968	80.00	2.50	1.643
RTU 2006942	80.00	3.00	1.959
RTU 2000339	80.00	4.00	2.580
RTU 2006715	80.00	5.00	3.180
RTU 3020292	80.00	6.00	3.766
RTU 2001180	80.00	8.00	4.885
RTU 3006761	80.00	8.00	4.885
RTU 2020170	80.00	9.25	5.551
RTU 2001187	80.00	10.00	5.930
RTU 2006811	80.00	10.00	5.937
RTU 3006957	80.00	10.00	5.937

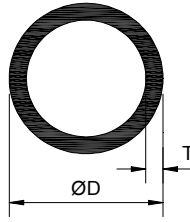
TUBES : ROUND

Section No	D	T	Kg/m
RTU 3006983	80.00	12.00	6.921
RTU 2006611	80.00	15.00	8.270
RTU 3006813	80.00	15.00	8.270
RTU 3006805	80.00	20.00	10.178
RTU 3020126	80.00	21.00	10.509
RTU 2006930	80.20	2.00	1.326
RTU 3020260	81.00	16.00	8.821
RTU 3020154	82.00	6.00	3.867
RTU 3020156	82.00	13.50	7.844
RTU 3006864	82.00	16.00	8.957
RTU 3020190	82.00	17.00	9.372
RTU 3020113	82.00	19.00	10.153
RTU 3006738	82.00	25.00	12.087
RTU 2001192	82.50	3.25	2.180
RTU 1020133	82.55	1.65	1.132
RTU 2000340	84.00	3.00	2.061
RTU 2000297	84.00	14.00	8.300
RTU 3020293	85.00	5.00	3.392
RTU 3006816	85.00	10.00	6.361
RTU 3006806	85.00	15.00	8.906
RTU 2006773	85.50	2.75	1.929
RTU 2006604	85.60	3.00	2.101
RTU 2000273	86.00	9.00	5.875
RTU 3006887	86.00	21.00	11.578
RTU 2020038	87.00	2.30	1.652
RTU 2006624	87.00	3.50	2.479
RTU 3006837	88.50	5.29	3.733
RTU 3006836	88.75	7.48	5.153
RTU 1020051	88.90	1.65	1.221
RTU 3006854	88.90	3.04	2.214
RTU 2006752	88.90	5.00	3.558
RTU 2000324	88.90	5.49	4.471
RTU 2000259	88.90	6.35	4.450
RTU 2000307	88.90	7.62	5.750
RTU 3006851	88.90	7.62	5.253
RTU 3006734	88.90	7.95	5.458
RTU 2006646	88.90	9.00	6.214
RTU 3006749	89.00	9.60	6.465

Section No	D	T	Kg/m
RTU 3020105	89.00	10.50	6.991
RTU 3006849	89.00	24.50	13.404
RTU 3006857	89.92	6.48	4.586
RTU 3006791	90.00	3.00	2.213
RTU 3006822	90.00	3.00	2.213
RTU 2006689	90.00	5.00	3.604
RTU 2006831	90.00	5.00	3.604
RTU 3006971	90.00	6.00	4.275
RTU 3006810	90.00	10.00	6.785
RTU 3006913	90.00	11.00	7.371
RTU 2006826	90.00	15.00	9.542
RTU 3006765	90.00	16.50	10.286
RTU 3006865	90.00	17.50	10.716
RTU 3006888	90.00	19.00	11.442
RTU 3006884	90.00	20.00	11.875
RTU 3006962	90.00	25.00	13.784
RTU 3006824	91.00	19.50	11.826
RTU 3020114	91.00	23.50	13.455
RTU 3020007	92.00	12.50	8.429
RTU 3020136	92.00	13.00	8.711
RTU 3020137	92.00	17.00	10.814
RTU 2006933	92.50	2.50	1.908
RTU 2020186	93.00	2.00	1.543
RTU 3020054	95.00	12.50	8.747
RTU 3020127	95.00	27.50	15.745
RTU 3006772	96.50	5.50	4.245
RTU 3020065	97.00	26.00	15.658
RTU 3006960	98.00	4.00	3.189
RTU 3006899	100.00	2.90	2.388
RTU 2006614	100.00	3.00	2.468
RTU 2006690	100.00	4.00	3.257
RTU 2006716	100.00	5.00	4.029
RTU 2006781	100.00	5.00	4.029
RTU 2000334	100.00	6.00	4.785
RTU 2000373	100.00	8.00	6.240
RTU 3006759	100.00	8.00	6.242
RTU 3006770	100.00	10.00	7.634
RTU 3006807	100.00	10.00	7.634

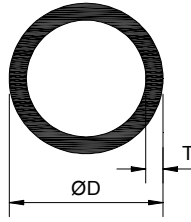
TUBES : ROUND

Section No	D	T	Kg/m
RTU 3006817	100.00	12.50	9.277
RTU 3020189	100.00	15.00	10.814
RTU 3020210	100.00	20.00	13.571
RTU 3020214	100.15	19.00	13.078
RTU 3020288	100.15	21.00	14.098
RTU 2006980	101.00	3.00	2.493
RTU 2000375	101.00	8.85	6.917
RTU 3006777	101.00	13.00	9.703
RTU 3006754	101.00	15.50	11.241
RTU 2000260	101.60	3.00	2.500
RTU 2000299	101.60	5.74	4.664
RTU 2006688	101.60	8.08	6.409
RTU 2000353	102.00	3.90	3.325
RTU 3020103	102.50	6.25	5.102
RTU 2000298	102.50	7.00	5.660
RTU 3020243	103.00	11.25	9.466
RTU 3006748	103.00	17.50	12.691
RTU 3006866	103.00	20.00	14.080
RTU 2001185	105.00	13.50	10.476
RTU 3006774	106.00	3.00	2.619
RTU 3020008	106.00	15.50	11.898
RTU 2000328	106.70	3.50	3.062
RTU 3006976	107.00	6.00	5.140
RTU 3020048	107.90	3.00	2.669
RTU 3020019	108.00	3.00	2.671
RTU 2006625	108.00	4.00	3.529
RTU 3006845	108.00	10.50	8.683
RTU 3006924	108.00	25.00	17.600
RTU 3020153	109.00	21.00	15.675
RTU 2006712	110.00	5.00	4.453
RTU 3007000	110.00	5.00	4.453
RTU 3006756	110.00	11.50	9.608
RTU 2000335	110.00	17.50	13.723
RTU 3006812	110.00	20.00	15.268
RTU 3006985	112.00	13.50	11.279
RTU 3006914	112.00	21.50	16.504
RTU 3000300	114.20	6.10	5.600
RTU 3006869	114.20	8.51	8.615

Section No	D	T	Kg/m
RTU 3006724	114.30	3.00	2.832
RTU 3006741	114.30	6.10	5.598
RTU 3000301	114.30	8.56	7.677
RTU 3006764	114.30	8.56	7.677
RTU 3006963	114.30	8.70	8.769
RTU 3006872	115.00	10.50	9.307
RTU 3006739	115.00	11.50	10.096
RTU 3006907	115.00	15.00	12.723
RTU 3020031	116.00	13.88	12.019
RTU 3020155	116.50	10.75	9.642
RTU 2006651	117.00	7.50	6.966
RTU 3006819	120.00	3.00	2.977
RTU 3006820	120.00	5.00	4.877
RTU 3006982	120.00	8.00	7.600
RTU 3006793	120.00	10.00	9.330
RTU 3006843	120.00	12.00	10.993
RTU 3006870	120.00	12.00	11.477
RTU 3006755	120.00	13.00	11.798
RTU 3006946	120.00	15.00	13.359
RTU 3020084	122.00	9.50	9.065
RTU 2006634	122.00	21.00	17.990
RTU 3006840	125.00	10.00	9.754
RTU 3006771	126.00	9.50	9.387
RTU 3006751	126.00	16.25	15.127
RTU 2000336	127.00	3.00	3.155
RTU 3000337	127.00	6.35	6.500
RTU 3006846	127.00	9.02	9.026
RTU 3006863	127.00	9.50	9.468
RTU 3006744	127.00	13.97	13.393
RTU 3000371	128.00	7.50	7.661
RTU 3020294	130.00	5.00	5.301
RTU 3006794	130.00	10.00	10.178
RTU 3006973	130.00	15.00	14.631
RTU 3006961	130.00	20.00	18.661
RTU 3020032	131.00	3.00	3.257
RTU 3006997	131.00	5.50	5.854
RTU 2000330	131.70	3.50	3.806
RTU 3020139	131.80	5.00	5.377

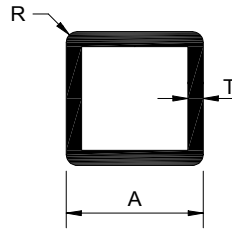
TUBES : SQUARE

Section No	A	T	R	Kg/m	Section No	A	T	R	Kg/m
STU 1007030	10.00	1.20	0.50	0.118	STU 2002103	40.00	1.80		0.742
STU 1007041	15.00	2.00	0.50	0.280	STU 2007003	40.00	2.00		0.820
STU 2007052	15.80	2.50	2.00	0.349	STU 2007017	40.00	2.00	3.00	0.802
STU 1007021	16.00	1.00	2.0	0.155	STU 2007045	40.00	2.00	4.00	0.792
STU 1007070	16.00	1.50		0.234	STU 2007004	40.00	3.00		1.198
STU 1007048	19.00	1.00		0.194	STU 2007049	40.00	3.00	3.00	1.180
STU 1001216	19.00	1.60		0.300	STU 2007010	40.00	4.00		1.555
STU 1001273	19.00	2.50	2.50	0.431	STU 2007006	45.00	2.00		0.928
STU 1002102	19.30	1.20		0.233	STU 1007058	50.00	1.60		0.835
STU 1007063	20.00	1.20		0.243	STU 2007007	50.00	2.00		1.036
STU 2007014	20.00	1.50		0.299	STU 2002104	50.00	2.70		1.378
STU 2007034	20.00	1.50		0.299	STU 2007009	50.00	3.00		1.522
STU 2007015	20.00	2.00		0.388	STU 2007008	50.00	4.00		1.987
STU 2007055	20.00	3.00		0.550	STU 3007036	50.00	5.00		2.429
STU 1001217	24.00	2.50		0.580	STU 2001227	50.80	2.00		1.054
STU 2007005	25.00	2.00		0.496	STU 2007072	50.80	3.25		1.668
STU 1001298	25.00	1.20		0.308	STU 2007042	60.00	2.00		1.252
STU 1007033	25.00	1.50		0.380	STU 2007013	60.00	3.00		1.846
STU 2007020	25.00	1.65		0.416	STU 3007022	60.00	4.00	0.50	2.419
STU 3007028	25.00	2.00	3.00	0.478	STU 3007051	60.00	4.50	1.00	3.002
STU 2007012	25.00	3.00		0.712	STU 2001226	61.50	4.00		2.470
STU 2007060	25.00	3.00	4.00	0.678	STU 2001229	62.50	2.50		1.620
STU 3007025	25.40	3.20		0.766	STU 2001274	67.50	8.25		5.278
STU 1007075	25.40	3.25		0.776	STU 2007031	70.00	1.90		1.396
STU 1002101	30.00	1.40		0.431	STU 2007016	70.00	4.00		2.850
STU 2007011	30.00	2.00		0.604	STU 2007061	70.00	4.00		2.850
STU 2007018	30.00	3.00		0.874	STU 2007001	74.50	2.00		1.566
STU 2007053	30.00	3.00	3.00	0.853	STU 3001272	80.00	2.00		1.684
STU 3007026	31.75	3.20		0.986	STU 3007027	80.00	3.00		2.494
STU 1007046	34.00	1.50	3.00	0.510	STU 3007023	80.00	4.00	0.50	3.283
STU 2007019	35.00	2.00		0.712	STU 3007029	80.00	4.00	4.00	3.414
STU 2007044	35.00	2.00	4.00	0.684	STU 3007057	80.00	5.00		4.049
STU 2007054	35.00	3.00		1.036	STU 2001230	81.00	8.00	1.00	6.307
STU 1007037	38.00	1.55		0.609	STU 2001228	87.50	4.00		3.607
STU 2007047	38.00	2.00	2.00	0.768	STU 3007040	90.00	4.00		3.714
STU 2001296	38.00	2.50		0.958	STU 3007073	99.50	4.00	6.00	4.051
STU 2001223	38.00	3.20		1.205	STU 3007039	100.00	2.00		2.116
STU 1007074	38.10	3.25		1.222	STU 3007038	100.00	2.80		2.938

TUBES : RECTANGULAR

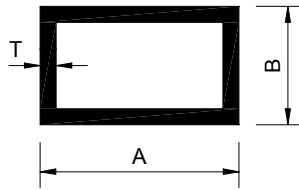

Section No	A	B	T	Kg/m	Section No	A	B	T	Kg/m
RET 1007199	20.00	10.00	1.50	0.218	RET 2007189	50.00	15.00	2.00	0.658
RET 1007197	20.00	10.00	2.00	0.280	RET 2007135	50.00	20.00	2.00	0.712
RET 2007169	20.00	15.00	2.00	0.334	RET 1007146	50.00	25.00	2.00	0.766
RET 1001261/L	24.00	12.00	1.17	0.212	RET 2002060	50.00	25.00	2.30	0.873
RET 1001261/H	24.00	12.00	1.26	0.227	RET 3007168	50.00	25.00	3.00	1.117
RET 1001262/M	24.00	18.00	0.80	0.180	RET 2007128	50.00	30.00	2.00	0.820
RET 1007182	30.00	10.00	1.50	0.299	RET 2007125	50.00	30.00	3.00	1.198
RET 1027012	30.00	15.00	1.50	0.339	RET 2027008	50.00	38.00	3.00	1.327
RET 1007183	30.00	15.00	2.00	0.442	RET 1007164	50.00	40.00	2.00	0.928
RET 1007177	30.00	20.00	1.50	0.380	RET 2007184	50.00	40.00	3.00	1.360
RET 2007110	30.00	20.00	2.00	0.496	RET 2007130	50.80	25.40	2.00	0.779
RET 1027003	30.00	22.00	1.50	0.396	RET 3007139	50.80	25.40	3.20	1.205
RET 1027002	31.00	9.00	2.40	0.455	RET 1007173	60.00	20.00	2.00	0.820
RET 1001265/L	35.00	24.00	0.88	0.272	RET 2007121	60.00	25.00	3.00	1.279
RET 1001265/M	35.00	24.00	1.07	0.328	RET 2007112	60.00	30.00	2.00	0.928
RET 1001265/H	35.00	24.00	1.30	0.395	RET 2007107	60.00	30.00	3.00	1.360
RET 1007147	36.00	24.00	2.00	0.604	RET 1001270/M	60.00	35.00	0.81	0.413
RET 3007141	37.00	30.00	2.00	0.679	RET 1001270/H	60.00	35.00	0.92	0.462
RET 1027000	40.00	10.00	2.00	0.496	RET 2001270/HH	60.00	35.00	1.83	0.902
RET 1007163	40.00	15.00	1.50	0.421	RET 2001270/EH	60.00	35.00	3.30	1.575
RET 1007192	40.00	15.00	2.00	0.550	RET 2007117	60.00	40.00	2.00	1.036
RET 2007120	40.00	20.00	1.50	0.461	RET 2007118	60.00	40.00	3.00	1.522
RET 2002058	40.00	20.00	1.80	0.547	RET 2007175	60.00	40.00	2.50	1.281
RET 2007111	40.00	20.00	2.00	0.604	RET 2007122	60.00	40.00	4.00	1.987
RET 2007116	40.00	30.00	2.00	0.712	RET 1007181	60.00	50.00	2.00	1.144
RET 2007131	40.00	20.00	3.00	0.874	RET 1001269/H	61.50	24.00	1.00	0.397
RET 2007155	40.00	25.00	2.00	0.658	RET 2001263	63.50	25.40	3.00	1.345
RET 2007106	40.00	30.00	3.00	1.036	RET 1007187	63.50	38.10	1.25	0.668
RET 2007101	45.00	15.00	2.50	0.742	RET 1007138	63.50	38.10	1.40	0.746
RET 3007132	45.00	20.00	2.00	0.658	RET 1007188	63.50	38.10	1.75	0.926
RET 1027005	45.00	25.00	2.00	0.712	RET 3007133	65.00	50.00	3.00	1.765
RET 2007104	47.00	44.45	2.00	0.944	RET 2027006	70.00	30.00	3.00	1.522
RET 1001267/L	48.00	24.00	0.83	0.315	RET 2007153	70.00	50.00	4.00	2.418
RET 1001267/M	48.00	24.00	0.90	0.341	RET 2007144	70.00	50.00	5.50	3.234
RET 1001267/H	48.00	24.00	1.09	0.411	RET 1001280/M	72.00	24.00	0.86	0.437
RET 1001267/HH	48.00	24.00	1.54	0.573	RET 1001280/H	72.00	24.00	1.05	0.532
RET 1027001	50.00	10.00	2.00	0.604	RET 1027004	72.00	24.00	1.20	0.606
RET 1007178	50.00	12.00	1.50	0.477	RET 2007145	74.00	21.00	3.00	1.441

TUBES : RECTANGULAR

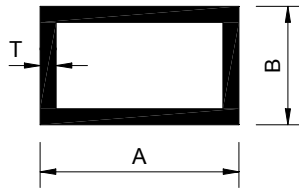

Section No	A	B	T	Kg/m	Section No	A	B	T	Kg/m
RET 2007102	74.80	25.10	1.63	0.851	RET 2002063	100.00	50.00	1.80	1.422
RET 1007159	75.00	19.00	1.50	0.736	RET 2007127	100.00	50.00	3.00	2.332
RET 3007170	75.00	25.00	6.00	2.850	RET 2002064	100.00	50.00	3.20	2.480
RET 2001271	75.00	50.00	3.00	1.927	RET 2002062	100.00	50.00	3.45	2.666
RET 1007195	76.00	44.00	1.20	0.761	RET 2007200	100.00	50.00	2.00	1.576
RET 1027019	80.00	20.00	2.00	1.036	RET 2007126	100.00	50.00	4.00	3.066
RET 2007108	80.00	30.00	2.00	1.144	RET 2007103	100.00	50.00	5.00	3.780
RET 2002054	80.00	40.00	1.20	0.761	RET 3007185	100.00	60.00	4.00	3.282
RET 1007193	80.00	40.00	1.30	0.823	RET 1007194	101.00	44.45	1.50	1.153
RET 2007113	80.00	40.00	2.00	1.252	RET 1007148	101.60	25.40	1.02	0.688
RET 2007176	80.00	40.00	2.50	1.551	RET 1007149	101.60	25.40	1.06	0.714
RET 2007114	80.00	40.00	3.00	1.846	RET 1007150	101.60	25.40	1.17	0.787
RET 3007136	80.00	40.00	4.00	2.419	RET 2002052	101.60	44.45	1.20	0.930
RET 3007134	80.00	50.00	3.00	2.008	RET 2001284/L	101.60	44.50	1.25	0.969
RET 2007123	80.00	50.00	4.00	2.635	RET 2001284/M	101.60	44.50	1.30	1.007
RET 3007154	80.00	50.00	10.00	5.930	RET 2001284/H	101.60	44.50	1.41	1.090
RET 1007165	81.00	38.00	1.60	0.999	RET 2001284/H1	101.60	44.50	1.77	1.362
RET 2007171	83.00	45.00	2.00	1.338	RET 2001284/H2	101.60	44.50	2.36	1.801
RET 2027014	90.00	70.00	2.00	1.684	RET 2001284/EH	101.60	44.50	3.00	2.269
RET 3027016	96.00	53.00	5.00	3.751	RET 3007140	101.60	50.80	3.20	2.522
RET 1007191	100.00	18.00	2.00	1.230	RET 2027011	120.00	20.00	2.00	1.468
RET 1007158	100.00	19.00	1.50	0.939	RET 2001285/L	120.00	24.00	1.18	0.902
RET 2007156	100.00	20.00	2.00	1.252	RET 2001285/M	120.00	24.00	1.25	0.970
RET 1001282/L	100.00	24.00	1.01	0.671	RET 2001285/H	120.00	24.00	1.40	1.067
RET 1001282/M	100.00	24.00	1.07	0.704	RET 3007190	120.00	30.00	3.00	2.332
RET 1001282/H	100.00	24.00	1.17	0.768	RET 2002056	120.00	40.00	1.60	1.354
RET 1007167	100.00	24.00	1.60	1.043	RET 2027018	120.00	40.00	2.00	1.684
RET 2007105	100.00	30.00	2.00	1.360	RET 2027017	120.00	40.00	3.00	2.494
RET 2001283/L	100.00	35.00	1.15	0.824	RET 2007124	120.00	40.00	4.00	3.283
RET 2001283/M	100.00	35.00	1.20	0.852	RET 2027020	120.00	45.00	2.00	1.738
RET 2001283/H	100.00	35.00	1.25	0.901	RET 3007152	120.00	50.00	2.00	1.790
RET 2002059	100.00	38.00	1.00	0.806	RET 2007198	120.00	50.00	2.60	2.399
RET 2007166	100.00	38.00	2.00	1.446	RET 3007157	120.00	50.00	4.00	3.498
RET 2002053	100.00	40.00	1.20	0.891	RET 2027010	120.00	60.00	3.00	2.818
RET 2002055	100.00	40.00	1.60	1.181	RET 3027009	120.00	60.00	4.00	3.714
RET 2007179	100.00	40.00	2.50	1.821	RET 3027022	120.00	80.00	3.00	3.142
RET 2007196	100.00	40.00	3.00	2.170	RET 2001288	124.00	25.00	1.23	0.973
RET 2007115	100.00	40.00	4.00	2.851	RET 2001287	125.40	35.20	2.30	1.937

ANGLES : EQUAL

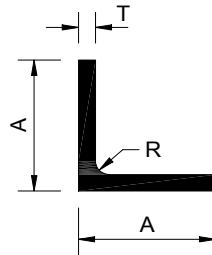

Section No	A	T	R	Kg/m	Section No	A	T	R	Kg/m
ANG 1006534	10.00	2.00		0.096	ANG 1006529	40.00	2.00		0.421
ANG 1006548	12.50	2.00		0.123	ANG 1018025	40.00	2.00		0.421
ANG 1006575	15.00	2.00		0.150	ANG 1006543	40.00	2.00	20.00	0.376
ANG 1002209	19.05	1.00		0.099	ANG 2002204	40.00	3.00		0.623
ANG 1002219	19.05	2.30		0.233	ANG 2006553	40.00	3.00		0.623
ANG 1002216	20.00	1.20		0.125	ANG 1018027	40.00	3.00		0.623
ANG 1002201	20.00	1.50		0.155	ANG 2002218	40.00	4.00		0.820
ANG 1006518	20.00	2.00		0.205	ANG 2006502	40.00	4.00		0.820
ANG 2006501	20.00	3.00		0.299	ANG 2006546	40.00	5.00		1.011
ANG 1001519	25.00	1.25		0.165	ANG 2001515	40.00	6.50		1.150
ANG 1002222	25.00	1.50		0.196	ANG 2006547	50.00	1.70	1.00	0.451
ANG 1018023	25.00	1.50		0.196	ANG 2006507	50.00	2.00		0.529
ANG 1002202	25.00	2.00		0.258	ANG 2002205	50.00	3.00		0.785
ANG 1006551	25.00	2.00		0.258	ANG 2006524	50.00	3.00		0.785
ANG 2001507	25.00	3.00		0.380	ANG 2002207	50.00	4.00		1.036
ANG 2006597	25.00	3.00	3.00	0.380	ANG 2002206	50.00	5.00		1.282
ANG 2006582	25.00	4.00		0.496	ANG 2006554	50.00	5.00		1.281
ANG 2001522	25.00	5.00		0.610	ANG2018032	50.00	8.00		1.986
ANG 2002211	25.40	2.80		0.362	ANG 3018033	50.00	10.00		2.429
ANG 2006588	25.40	3.20		0.410	ANG 2002215	50.80	3.00		0.798
ANG 2002221	28.00	2.50		0.360	ANG 2001516	50.80	3.00		0.800
ANG 2006520	30.00	2.00		0.313	ANG 2006567	50.80	3.17	6.35	0.854
ANG 2006523	30.00	3.00		0.461	ANG 2001517	50.80	4.76	6.10	1.263
ANG 2006552	30.00	3.00		0.461	ANG 2001518	50.80	6.00		1.625
ANG 2006581	30.00	4.00		0.604	ANG 3006563	50.80	6.35	6.35	1.655
ANG 2002203	30.00	5.00		0.740	ANG 2018052	50.80	6.35		1.632
ANG 2018030	30.00	5.00		0.741	ANG 1006566	60.00	3.00		0.946
ANG 2001509	31.75	3.18	5.08	0.538	ANG 2006590	60.00	4.00		1.252
ANG 1018053	31.75	3.18		0.517	ANG 2018035	60.00	5.00		1.551
ANG 1018012	35.00	2.00		0.366	ANG 2006530	60.00	6.00		1.846
ANG 1001521	37.00	1.50		0.297	ANG 3018036	60.00	8.00		2.418
ANG 1001525	37.00	1.50		0.322	ANG 3018007	60.00	8.00	7.00	2.446
ANG 1006513	38.00	2.00		0.399	ANG 3006570	60.00	10.00		2.969
ANG 1018003	38.00	2.50		0.495	ANG 3018005	65.00	5.00		1.686
ANG 2001511	38.00	3.00		0.590	ANG 2001523	65.00	6.00		2.054
ANG 2002213	38.10	3.00		0.592	ANG 2006510	70.00	7.00		2.513
ANG 2001512	38.10	3.17	5.33	0.639	ANG 2002225	75.00	5.00		1.956
ANG 2001513	38.10	4.76	5.33	0.935	ANG 2006565	75.00	3.00		1.189

ANGLES: UNEQUAL

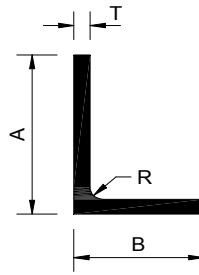

Section No	A	B	T	R	Kg/m	Section No	A	B	T	R	Kg/m
ANG 1006539	19.00	16.50	1.50		0.137	ANG 1018009	60.00	30.00	3.00		0.703
ANG 1006591	20.00	10.00	2.00		0.150	ANG 3006541	60.00	30.00	4.00		0.928
ANG 1006559	25.00	15.00	2.00		0.204	ANG 1018034	60.00	30.00	5.00		1.146
ANG 2006592	25.00	15.00	3.00		0.298	ANG 2006503	60.00	40.00	3.00		0.785
ANG 1006569	30.00	15.00	2.00		0.231	ANG 1006550	60.00	40.00	2.00		0.529
ANG 1018026	30.00	15.00	2.00		0.231	ANG 1018051	60.00	40.00	2.50		0.657
ANG 2006593	30.00	15.00	3.00		0.339	ANG 2006509	60.00	40.00	4.00		1.036
ANG 2006537	30.00	20.00	2.00		0.259	ANG 2006517	60.00	40.00	5.00		1.282
ANG 1018020	30.00	20.00	2.00		0.259	ANG 2006532	60.00	40.00	10.00		2.429
ANG 2006598	30.00	25.00	3.00		0.420	ANG 2006580	60.00	50.00	3.00		0.865
ANG 2006594	35.00	15.00	3.00		0.379	ANG 2006578	63.00	20.00	3.00		0.647
ANG 2006544	38.10	30.50	3.20	1.50	0.562	ANG 2001532	63.50	50.80	4.76	6.60	1.430
ANG 2006585	40.00	15.00	2.00		0.285	ANG 3018006	63.50	50.80	4.80	5.00	1.432
ANG 1006514	40.00	20.00	2.00		0.312	ANG 2006596	70.00	50.00	5.00		1.551
ANG 2018022	40.00	20.00	2.00		0.312	ANG 2006561	75.00	50.00	5.00		1.619
ANG 2006506	40.00	20.00	3.00		0.461	ANG 2001533	76.20	50.80	6.35	6.86	2.094
ANG 3018014	40.00	28.50	12.00		1.829	ANG 2006525	80.00	40.00	4.00		1.252
ANG 1018000	40.00	30.00	2.00		0.366	ANG 2018037	80.00	40.00	5.00		1.551
ANG 1006579	40.00	30.00	3.00		0.541	ANG 2018038	80.00	40.00	6.00		1.846
ANG 2006583	40.00	30.00	4.00		0.712	ANG 2006556	80.00	50.00	5.00		1.689
ANG 1006538	50.00	20.00	2.00		0.367	ANG 2006558	80.00	50.00	6.00		2.008
ANG 1018024	50.00	20.00	2.00		0.367	ANG 3006576	89.00	58.00	12.00	8.00	4.410
ANG 1006586	50.00	25.00	2.00		0.393	ANG 1018008	100.00	30.00	3.00		1.027
ANG 1006577	50.00	30.00	2.00		0.421	ANG 2006511	100.00	40.00	4.00		1.468
ANG 2006540	50.00	30.00	3.00		0.622	ANG 2006587	100.00	50.00	3.00		1.189
ANG 2018021	50.00	30.00	3.00		0.622	ANG 2006536	100.00	50.00	5.00		1.957
ANG 1018031	50.00	30.00	4.00		0.820	ANG 3018041	100.00	50.00	8.00		3.066
ANG 2018017	50.00	30.00	5.00		1.011	ANG 3018042	100.00	50.00	10.00		3.779
ANG 2006599	50.00	35.00	3.00		0.663	ANG 3018040	100.00	60.00	6.00		2.494
ANG 2006560	50.00	40.00	4.00		0.928	ANG 2006504	100.00	64.00	8.00		3.369
ANG 2006595	50.00	40.00	5.00		1.146	ANG 3006564	101.60	50.80	6.35	6.35	2.526
ANG 2018002	50.80	38.10	6.35	6.10	1.436	ANG 3018015	105.00	36.50	8.00		2.881
ANG 2006549	52.50	30.00	8.00	8.00	1.640	ANG 2006584	120.00	50.00	2.00		0.906
ANG 2018004	55.00	50.00	5.00		1.347	ANG 2006505	120.00	80.00	10.00		5.130
ANG 1006574	60.00	15.00	2.00		0.393	ANG 3006562	122.00	66.00	15.00		7.005
ANG 1018029	60.00	20.00	2.00		0.420	ANG 1006568	125.00	25.00	1.50		0.600
ANG 1018016	60.00	30.00	2.00		0.474	ANG 3018046	150.00	50.00	4.00		2.116

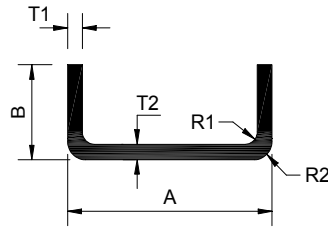
CHANNEL : UNEQUAL

Section No	A	B	T1	T2	R1	R2	Kg/m
HAD 1007480	8.70	25.00	2.00	2.00			0.294
HAD 1034209	9.00	15.00	1.20	1.20			0.117
HAD 1034347	10.00	25.00	1.75	1.75			0.266
HAD 1034136	15.00	20.00	2.00	2.00			0.274
HAD 1034018	18.00	30.00	2.00	2.00			0.398
HAD 1034128	20.00	15.00	2.00	2.00			0.247
HAD 2007459	20.00	30.00	2.00	2.00			0.409
HAD 2034280	20.00	30.00	3.00	3.00			0.598
HAD 2034095	22.00	8.00	2.50	2.50			0.221
HAD 1034016	22.00	30.00	2.00	2.00			0.420
HAD 2034334	24.00	20.00	2.00	2.00	3.00	5.00	0.304
HAD 2034103	25.00	20.00	2.00	2.00			0.328
HAD 1034106	25.00	50.00	2.75	2.75			0.886
HAD 2034335	28.00	20.00	2.00	2.00	3.00	5.00	0.326
HAD 1034165	30.00	20.00	2.00	2.00			0.355
HAD 1034420	30.00	20.00	2.00	2.00			0.355
HAD 2034376	35.00	25.00	2.00	2.00			0.436
HAD 1007556	40.00	20.00	2.00	2.00			0.409
HAD 1034336	40.00	20.00	2.00	2.00	3.00	5.00	0.391
HAD 2007428	40.00	20.00	3.00	3.00			0.599
HAD 2007576	40.00	30.00	3.00	3.00			0.760
HAD 3034113	40.00	49.00	9.40	10.00			3.058
HAD 1034170	50.00	25.00	1.80	1.80			0.467
HAD 2007436	50.00	25.00	2.00	2.00			0.518
HAD 2034116	50.00	25.00	2.50	2.50			0.640
HAD 2008542	50.00	25.00	3.00	3.00			0.761
HAD 1034164	50.00	30.00	2.00	2.00			0.571
HAD 1034072	50.00	30.00	3.00	3.00			0.841
HAD 2007444	50.00	40.00	4.00	4.00			1.317
HAD 2034182	50.00	40.00	5.00	5.00			1.619
HAD 3007482	50.80	25.40	3.17	3.17			0.814
HAD 2034118	53.50	30.00	3.00	3.00			0.869
HAD 1007469	54.50	50.00	2.00	2.00			0.812
HAD 1034337	55.00	20.00	2.00	2.00	3.00	5.00	0.472
HAD 2007450	60.00	30.00	4.00	4.00			1.209
HAD 3034059	60.00	40.00	3.00	3.00			1.084
HAD 3007486	60.00	40.00	4.00	4.00			1.424
HAD 3034073	60.00	40.00	5.00	5.00			1.754

CHANNEL : UNEQUAL

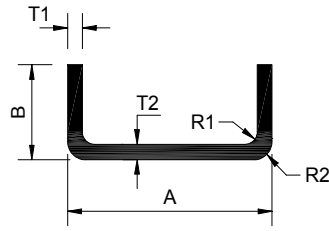

Section No	A	B	T1	T2	R1	R2	Kg/m
HAD 1034074	60.00	50.00	2.00	2.00			0.841
HAD 1007544	64.80	8.50	1.40	1.40			0.298
HAD 3034355	70.00	107.00	5.00	5.00	5.00	10.00	3.611
HAD 2001372	75.00	40.00	5.00	5.00	0.50	0.50	1.960
HAD 2001377	76.20	38.10	6.35	6.35	1.00	1.00	2.394
HAD 2007452	76.20	43.78	6.50	3.98	5.99	5.99	2.215
HAD 2007453	80.00	40.00	4.00	4.00			1.641
HAD 2007429	80.00	50.00	5.00	5.00			2.295
HAD 3034345	94.00	80.00	5.00	5.00	7.00	12.00	3.183
HAD 2034171	100.00	25.00	2.00	2.00			0.787
HAD 3034430	100.00	40.00	8.00	8.00			3.541
HAD 2034477	100.00	50.00	3.00	3.00			1.570
HAD 2007465	100.00	50.00	5.00	5.00			2.564
HAD 3034366	100.00	50.00	10.00	10.00		1.50	4.852
HAD 2007468	100.00	64.00	6.40	6.40			3.718
HAD 2001368	100.00	65.00	15.00	11.00	7.00		7.110
HAD 3034162	101.60	41.83	6.68	6.68			3.098
HAD 3007485	101.60	50.80	6.35	6.35			3.265
HAD 2001356	101.60	50.80	7.94	6.35	9.14		3.730
HAD 2034185	106.00	40.00	3.00	3.00			1.457
HAD 2007445	109.60	44.70	12.70	10.00	5.00	1.00	5.364
HAD 3034228	127.00	48.00	8.00	8.00	9.50		4.574
HAD 3034066	140.00	60.00	7.00	7.00			4.648
HAD 3007478	140.00	70.00	8.00	8.00			5.701
HAD 3007479	160.00	80.00	10.00	10.00			8.099

TEES : REGULAR

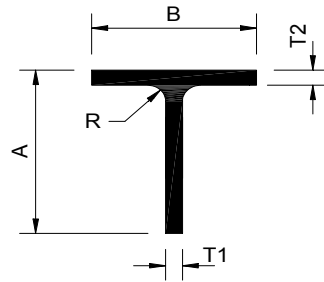

Section No	A	B	T1	T2	R	Kg/m
HAD 1001465	18.00	18.00	1.90	1.90		0.170
HAD 1034144	20.00	20.00	2.00	2.00		0.204
HAD 2034229	30.00	50.00	2.50	2.50		0.523
HAD 1001463	37.00	37.00	1.50	1.50		0.300
HAD 2007526	24.00	45.00	8.00	3.00		0.817
HAD 2007497	26.50	72.00	2.00	2.00	1.00	0.522
HAD 1007523	45.00	90.00	2.00	2.00		0.718
HAD 3007568	50.00	50.00	5.00	5.00		1.282
HAD 2034169	50.00	80.00	5.00	5.00		1.686
HAD 2007498	70.00	100.00	3.00	3.00		1.351
HAD 2034094	100.00	45.00	8.00	8.00		2.987
HAD 2034026	100.00	50.00	3.00	3.00		1.189
HAD 3007496	135.00	75.00	20.00	12.50		9.147

MODULAR

